



Communications & Data

**KEPS Technologies, Inc. d/b/a ACD.net**  
**FIBER OPTIC CABLE ROUTE**

**Project Number**  
**LC017770FO37011**

[517-999-9999](tel:517-999-9999)

1800 Grand River Ave  
Lansing MI 48906

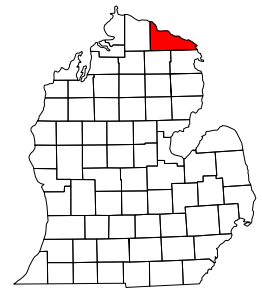
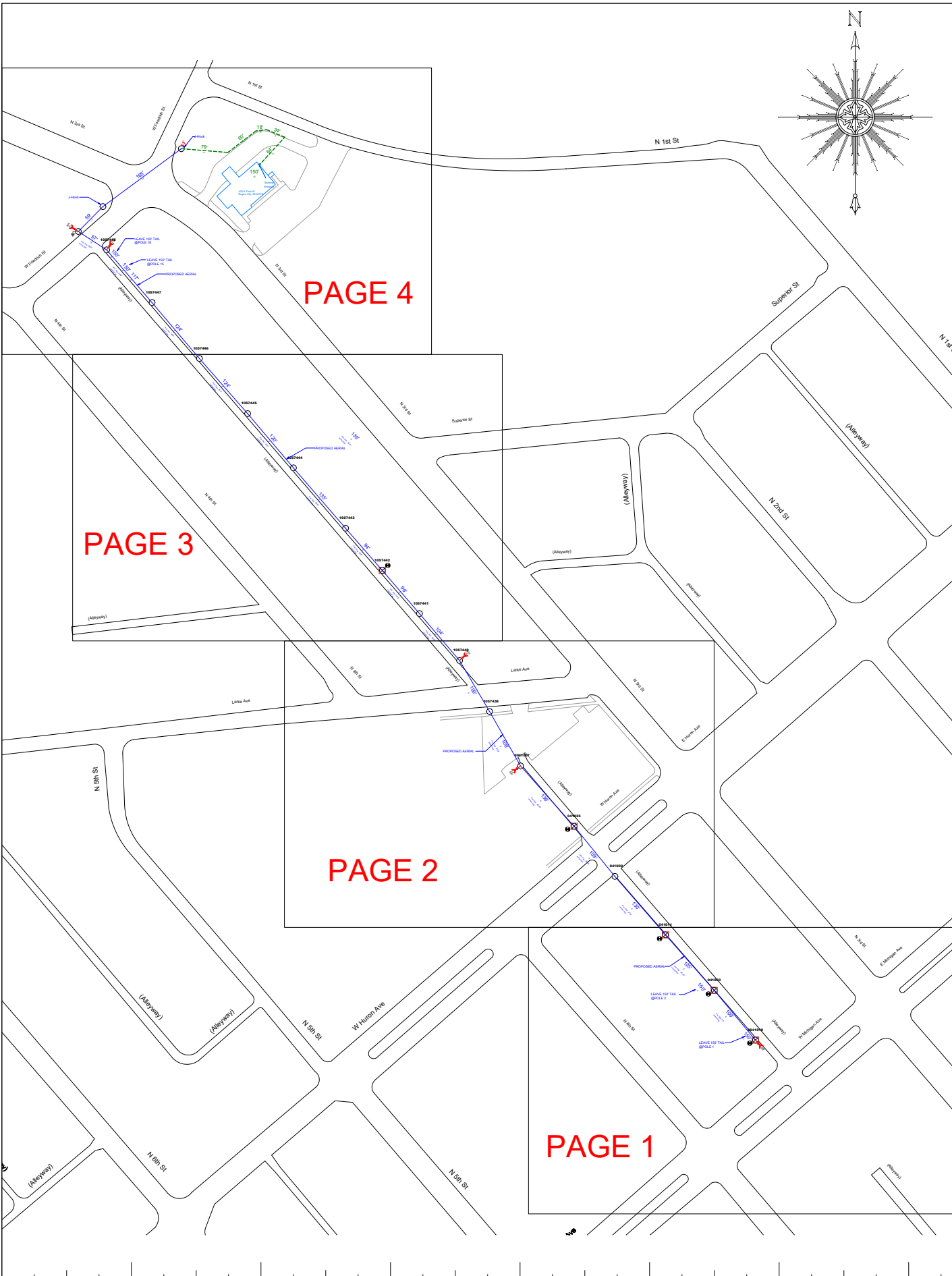

**ACD.NET**  
Advanced  
Communications & Data  
517-999-9999  
1800 Grand River Ave  
Lansing MI 48906

**PROPRIETARY**  
**INFORMATION NOT FOR DISCLOSURE**  
This Set of Plans contains confidential or proprietary information, and the recipient must not disclose, copy, re-create, or distribute the plans or the information contained therein, either directly or indirectly, to other entities or individuals without written or express permission from ACD.NET

**DRAWING DISCLAIMER**  
Facility Locations are general in nature, ACD.NET will not be held accountable for the accuracy of the information provided on these drawings. Contact the Local ONE CALL AGENCY 72 HOURS PRIOR TO CONSTRUCTION FOR EXACT UTILITY LOCATIONS AT:  
MISS DIG: 1-800-482-7171    O.U.P.S.: 1-800-362-2764    INDIANA811: 1-800-382-5544  
CAD Standard Ver. 72919

**Project Manager**

T. BROWN

**Permitting**

T. BROWN

**Transport Manager**

G. GOULD

**Drawn By    Date**

J. ANDERSON    10/31/22

**As Built    Date**

**Revisions**

| REV # | DESCRIPTION | BY | DATE |
|-------|-------------|----|------|
|       |             |    |      |
|       |             |    |      |
|       |             |    |      |
|       |             |    |      |
|       |             |    |      |
|       |             |    |      |
|       |             |    |      |
|       |             |    |      |
|       |             |    |      |

**Exhibit:** N/A

Remarks:  
SCALE: 1" = NTS  
COUNTY: PRESQUE ISLE    TOWNSHIP:    TRS:    CITY: ROGERS CITY    PROJECT ID: LC017770FO37011

PEACHTREE ID: 37011  
CUSTOMER NUMBER: 017770

**GRID KEY**

**CONSTRUCTION NOTES**

1. CONTRACTOR SHALL EMAIL [BROWN.TARA@ACD.NET](mailto:Brown.Tara@acd.net) WITH DAILY STATUS UPDATES AND ONCE WORK IS COMPLETE
2. MUNICIPALITY MUST BE NOTIFIED AT LEAST 48 HOURS BEFORE ANY WORK COMMENCES
3. ALL APPROPRIATE PERMITS AND ASSOCIATED DRAWINGS SHALL BE ON-SITE AT ALL TIMES DURING CONSTRUCTION
4. NOTIFY THE APPROPRIATE UTILITY NOTIFICATION SERVICE 72 HOURS PRIOR TO CONSTRUCTION.  
MICHIGAN- MISS DIG (1-800-482-1711), OHIO- O.U.P.S. (1-800-362-2764) OR INDIANA- INDIANA811 (1-800-382-5544)
5. ALL UTILITIES MUST BE FIELD VERIFIED
6. ALL HANDHOLES ARE TO INCLUDE 150' OF COILED FIBER FOR STORAGE
7. NEW INSTALLATION SHALL MAINTAIN 18" CLEARANCE FROM ALL EXISTING UTILITIES UNLESS NOTED OTHERWISE
8. ALL ROAD AND DRIVEWAY CROSSINGS WILL BE DIRECTIONAL BORED
9. CONSTRUCTION SHALL NOT DEVIATE FROM APPROVED PLANS WITHOUT WRITTEN CONSENT FROM BOTH THE MUNICIPALITY AND AN AUTHORIZED ACD.NET REPRESENTATIVE
10. PROPER SIGNAGE AND TRAFFIC CONTROL IS REQUIRED BEFORE STARTING ANY WORK WITHIN THE PUBLIC RIGHT OF WAY
11. ALL BACKFILL MATERIAL WITHIN THE ROAD RIGHT OF WAY OR NEAR SIDEWALKS AND PATHWAYS SHALL MEET THE REQUIREMENTS OF MDOT CLASS II MATERIAL, COMPACTED TO 95% OF ITS MAXIMUM DENSITY IN SUCCESSIVE LAYERS THAT ARE NO MORE THAN 12" THICK, UNLESS OTHERWISE AUTHORIZED
12. ALL SODDED AREAS THAT MAY DISTURBED DURING CONSTRUCTION ARE TO BE RESTORED WITH 3" QUALITY TOP SOIL, SEED AND MULCH
13. CONTRACTOR SHALL PROVIDE AS-BUILTS ON ALL WORK WITHIN 5 BUSINESS DAYS OF COMPLETION

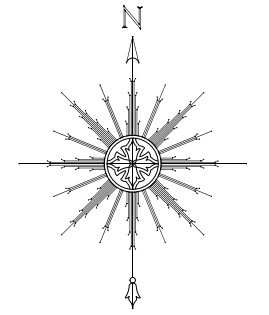

**ACD.NET**  
Advanced  
Communications & Data  
517-999-9999  
1800 Grand River Ave  
Lansing MI 48906

**PROPRIETARY  
INFORMATION NOT FOR  
DISCLOSURE**

This Set of Plans contains confidential or proprietary information, and the recipient must not disclose, copy, re-create, or distribute the plans or the information contained therein, either directly or indirectly, to other entities or individuals without written or express permission from ACD.NET

**DRAWING DISCLAIMER**

Facility Locations are general in nature, ACD.NET will not be held accountable for the accuracy of the information provided on these drawings. Contact the Local ONE CALL AGENCY 72 HOURS PRIOR TO CONSTRUCTION FOR EXACT UTILITY LOCATIONS AT:

|                            |                            |                              |
|----------------------------|----------------------------|------------------------------|
| MISS DIG<br>1-800-482-7171 | O.U.P.S.<br>1-800-362-2764 | INDIANA811<br>1-800-382-5544 |
|----------------------------|----------------------------|------------------------------|

CAD Standard Ver. 72919

**Project Manager**

T. BROWN

**Permitting**

T. BROWN

**Transport Manager**

G. GOULD

**Drawn By    Date**

J. ANDERSON    11/01/22

**As Built    Date**

**Revisions**

| REV # | DESCRIPTION | BY | DATE |
|-------|-------------|----|------|
|       |             |    |      |
|       |             |    |      |
|       |             |    |      |
|       |             |    |      |
|       |             |    |      |
|       |             |    |      |
|       |             |    |      |
|       |             |    |      |
|       |             |    |      |
|       |             |    |      |

**Exhibit:** N/A

|                      |           |                   |                             |                         |
|----------------------|-----------|-------------------|-----------------------------|-------------------------|
| Remarks:             |           |                   |                             | PEACHTREE ID: 37011     |
| SCALE: 1" = NTS      |           | TRS:              |                             | <b>NOTES</b>            |
| COUNTY: PRESQUE ISLE | TOWNSHIP: | CITY: ROGERS CITY | PROJECT ID: LC017770FO37011 |                         |
|                      |           |                   |                             | CUSTOMER NUMBER: 017770 |

|  |  |                                     |  |                        |  |   |
|--|--|-------------------------------------|--|------------------------|--|---|
| Proposed Anchor Distance and Direction                           |  | Fiber Count W/ Segment Number       |  | Man Hole               |  | <b>Typical Line Types</b><br><br><br><br><br><br><br><br><br><br><br><br><br><br><br><br><br><br><br><br><br><br> |
| Proposed ACD Communications Poles                                |  | Fiber Termination Point             |  | Storm Drain            |  |   |
| Proposed ACD NON Communications Pole                             |  | ACD Splice Case Six Way             |  | ACD Regen Cabinet      |  |   |
| Colocation Poles (ACD Communication Equipment on Existing Poles) |  | ACD Splice Case Four Way            |  | TRS Section Corner     |  |   |
| Joint Use Pole NON Transformer                                   |  | ACD Splice Case Three Way           |  | Fire Hydrant           |  |   |
| Joint Use Pole Transformer                                       |  | ACD Splice Case Two Way             |  | Location Address       |  |   |
| Foreign Pole Indicator   |  | ACD Fiber Tap Capsule               |  | Foliage                |  |   |
| Joint Use Pole NON Transformer- UNUSED                           |  | ACD RE-Box                          |  | Centerline Marker      |  |   |
| Joint Use Pole Transformer- UNUSED                               |  | Foreign Splice Case                 |  | Station Marker         |  |   |
| Street Light   |  | Storage Loop w/ Footage and Segment |  | Use of Double Dead End |  |   |
| Existing Traffic Signal Pole                                     |  | ACD Buried Cable Marker             |  |                        |  |   |
| Pole Number Marker   |  | ACD Hand Hole 17" x 12"             |  |                        |  |   |
| Proposed Riser   |  | ACD Hand Hole 24" x 13"             |  |                        |  |   |
| Make Ready Symbol w/ Attachment and Sag Heights                  |  | ACD Hand Hole 24" x 36"             |  |                        |  |   |
| Down Ground  |  | ACD Hand Hole 30" x 48"             |  |                        |  |   |
| Bonding Clamp  |  | Foreign Hand Hole                   |  |                        |  |   |
| Fiber Overlash   |  | Proposed Bore Pit Location          |  |                        |  |   |
| Overhead Guy Marker  |  | Communications Tower                |  |                        |  |   |
| Span Length and Segment ID                                       |  |                                     |  |                        |  |   |

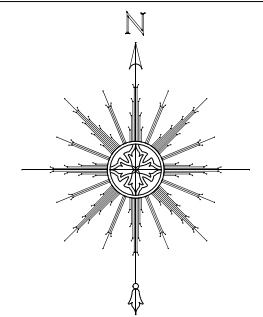

**ACD**  
Advanced  
Communications & Data  
517-999-9999  
1800 Grand River Ave  
Lansing MI 48906

**PROPRIETARY**  
INFORMATION NOT FOR DISCLOSURE  
This Set of Plans contains confidential or proprietary information, and the recipient must not disclose, copy, re-create, or distribute the plans or the information contained therein, either directly or indirectly, to other entities or individuals without written or express permission from ACD.NET

**DRAWING DISCLAIMER**  
Facility Locations are general in nature, ACD.NET will not be held accountable for the accuracy of the information provided on these drawings. Contact the Local ONE CALL AGENCY 72 HOURS PRIOR TO CONSTRUCTION FOR EXACT UTILITY LOCATIONS AT:  

|                |                |                |
|----------------|----------------|----------------|
| MISS DIG       | O.U.P.S        | INDIANA811     |
| 1-800-482-7171 | 1-800-362-2764 | 1-800-382-5544 |

 CAD Standard Ver. 72919

**Project Manager**

T. BROWN

**Permitting**

T. BROWN

**Transport Manager**

G. GOULD

|                 |             |
|-----------------|-------------|
| <b>Drawn By</b> | <b>Date</b> |
| J. ANDERSON     | 11/01/22    |

|                 |             |
|-----------------|-------------|
| <b>As Built</b> | <b>Date</b> |
|                 |             |

**Revisions**

| REV # | DESCRIPTION | BY | DATE |
|-------|-------------|----|------|
|       |             |    |      |
|       |             |    |      |
|       |             |    |      |
|       |             |    |      |
|       |             |    |      |
|       |             |    |      |
|       |             |    |      |
|       |             |    |      |
|       |             |    |      |
|       |             |    |      |

Our Match Lines can be found in the lower right hand corner and represents the neighboring page numbers.

|           |            |           |
|-----------|------------|-----------|
| WEST PAGE | NORTH PAGE | EAST PAGE |
|           | PAGE       |           |
|           | SOUTH PAGE |           |

**Exhibit:** N/A

|                      |           |                   |                             |                         |  |  |  |
|----------------------|-----------|-------------------|-----------------------------|-------------------------|--|--|--|
| Remarks:             |           |                   |                             | PEACHTREE ID: 37011     |  |  |  |
| SCALE: 1" = NTS      |           | TRRS:             |                             |                         |  |  |  |
| COUNTY: PRESQUE CITY | TOWNSHIP: | CITY: ROGERS CITY | PROJECT ID: LC017770FO37011 | CUSTOMER NUMBER: 017770 |  |  |  |
|                      |           |                   |                             | SYMBOLS                 |  |  |  |
|                      |           |                   |                             | LEGEND                  |  |  |  |



# General Site Preparation For Installing Hand Holes (All Sizes)

These guidelines for installing ACD Hand holes are provided as a general guide and actual site conditions may warrant the use of additional installations procedures not covered here. Follow all project specifications when installing ACD Hand holes.

1. Excavate the earth approximately 12" wider and longer than the hand hole as well as 6" deeper then the depth of the hand hole. Fill the excavation with a 6" base of pea stone or crushed rock to ensure proper drainage. Tamping is recommended to provide a compact and level surface for the hand hole to be place upon.
2. Wood bracing should be used inside the hand hole to ensure minimal sidewall deflection when backfilling. Temporary bracing can be constructed out of construction grade lumber. Start by using (1) 2x4 to brace the end walls and (2) 2x4s to brace the side walls, finish with (1) 2x4 from one side of the ring to the other. Do not install the bracing to tight to prevent damage.
3. Lift the Hand hole into the excavation using the lifting bolts or lifting wires. Check the top of the box is flush with the finished grade. Any necessary adjustments should be made to bring it to finished grade.
4. Backfill with clean, loose soil and compact to a minimum of 90%-95% compaction. Remove bracing materials and secure cover using included hardware.

## General Hand Hole Notes (All Sizes)

1. All Hand holes are to contain 150' of coiled up storage.
2. All Conduits are to be brought up through the bottom of the hand hole. No Conduits are to penetrate the sides of the enclosure. All conduits are to be tagged with the colored zip ties following this system:  
Red= Riser  
Blue= North  
Yellow= West  
Green= South  
Black= East
3. All Hand holes are to contain a 5/8" DIA x 8' grounding rod to be placed in a corner 3" away from each side and 18" above tamped earth.

## Restoration Notes

1. All backfill material within the road right of way or near sidewalks and pathways shall meet the requirements of MDOT Class II material, compacted to 95% of its maximum density in successive layers that are no more than 12" thick, unless otherwise authorized
2. All sodded areas that may disturbed during construction are to be restored with 3" quality top soil, seed and mulch
3. All Concrete/Sidewalk areas that may be disturbed are to be restored to a like or better condition.

## Underground Coupler Detail

### PUSH2CONNECT™ Coupler

## Do Not Unscrew!

**Push-On-Only!**  
(Loosening collars prior to installing can cause improper installation, create air loss, or coupler failure)

**Air Tight - Water Tight**  
Tested to **GREATER THAN 1500#**  
**Pull-Out**  
**GREATER THAN 450 (psi) air pass-through**

| Couplers for the Following Sizes  | Duct OD        | Color          | Box Qty | Part Number        |
|-----------------------------------|----------------|----------------|---------|--------------------|
| 1" Smoothwall HDPE                | 1.315"         | Yellow         | 85      | P2C-1.315          |
| 1.25" Smoothwall HDPE             | 1.66"          | Blue           | 100     | P2C-1.66           |
| 1.25" Smoothwall HDPE True Sized  | 1.58"          | Black          | 100     | P2C-1.58           |
| 2" Smoothwall HDPE                | 2.375"         | Orange         | 24      | P2C-2.375          |
| Transition Coupler 1.25" to 1.25" | 1.58" to 1.66" | Black AND Blue | 100     | P2C-1.66-1.58trans |

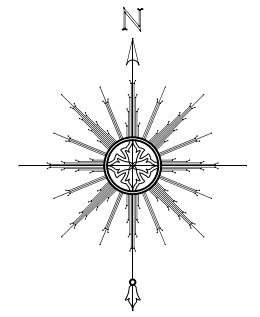
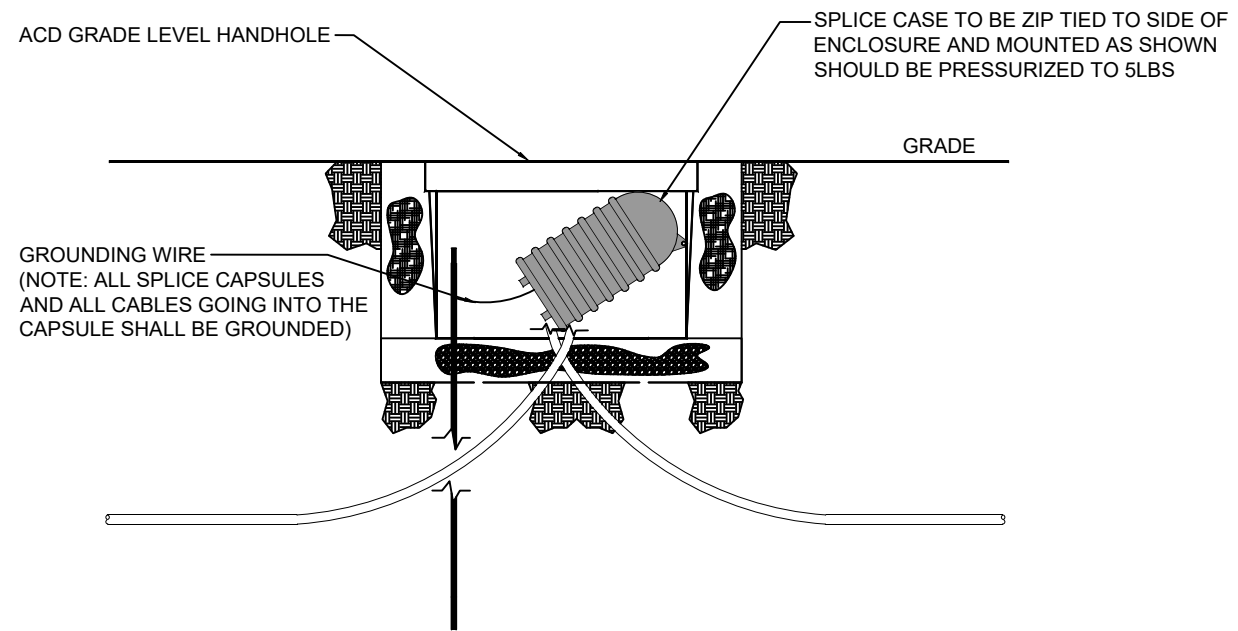
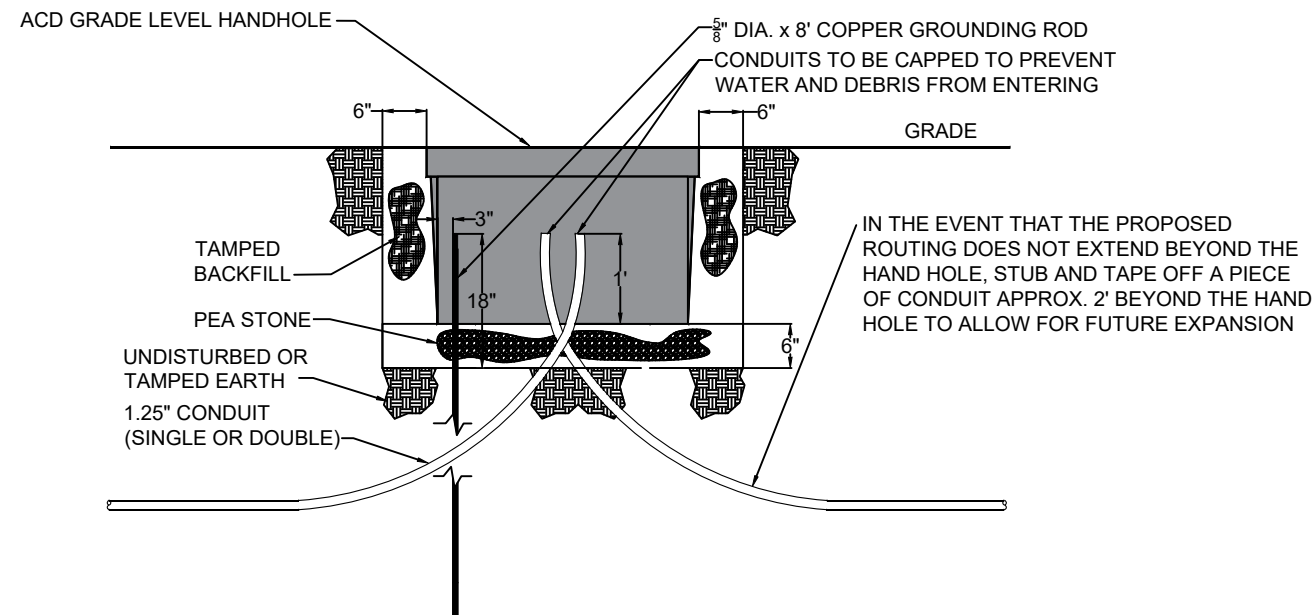
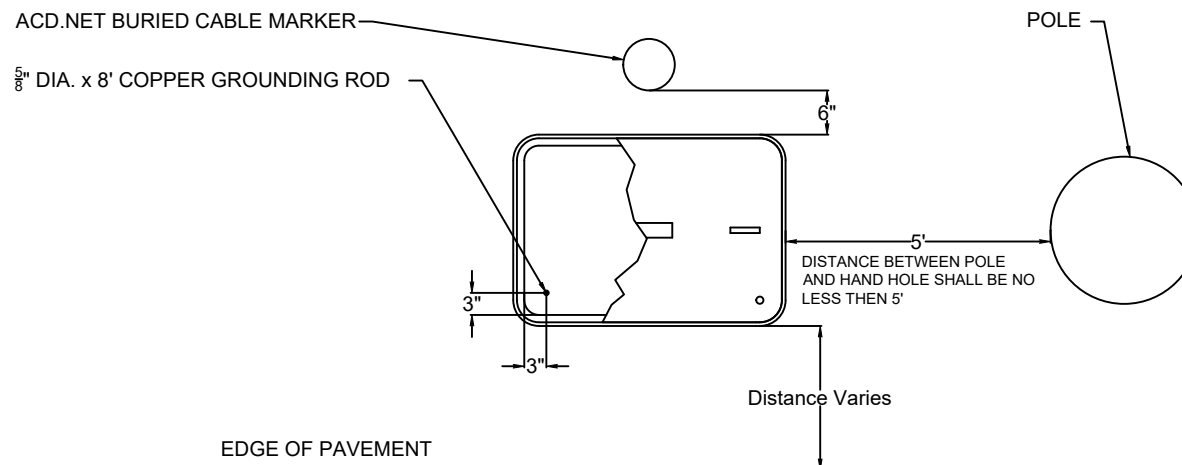

**ACD.NET**  
Advanced  
Communications & Data  
517-999-9999  
1800 Grand River Ave  
Lansing MI 48906

**PROPRIETARY INFORMATION NOT FOR DISCLOSURE**  
This Set of Plans contains confidential or proprietary information, and the recipient must not disclose, copy, re-create, or distribute the plans or the information contained therein, either directly or indirectly, to other entities or individuals without written or express permission from ACD.NET

**DRAWING DISCLAIMER**  
Facility Locations are general in nature, ACD.NET will not be held accountable for the accuracy of the information provided on these drawings. Contact the Local ONE CALL AGENCY 72 HOURS PRIOR TO CONSTRUCTION FOR EXACT UTILITY LOCATIONS AT:  
MISS DIG 1-800-482-7171 O.U.P.S. 1-800-362-2764 INDIANA811 1-800-382-5544  
CAD Standard Ver. 72919

### Project Manager

T. BROWN

### Permitting

T. BROWN

### Transport Manager

G. GOULD

| Drawn By    | Date     |
|-------------|----------|
| J. ANDERSON | 11/01/22 |
| As Built    | Date     |
|             |          |

### Revisions

| REV # | DESCRIPTION | BY | DATE |
|-------|-------------|----|------|
|       |             |    |      |
|       |             |    |      |
|       |             |    |      |
|       |             |    |      |
|       |             |    |      |
|       |             |    |      |
|       |             |    |      |
|       |             |    |      |
|       |             |    |      |
|       |             |    |      |
|       |             |    |      |
|       |             |    |      |
|       |             |    |      |
|       |             |    |      |
|       |             |    |      |
|       |             |    |      |
|       |             |    |      |
|       |             |    |      |

**Exhibit:** N/A

|                      |           |                     |                             |
|----------------------|-----------|---------------------|-----------------------------|
| Remarks:             |           | PEACHTREE ID: 37011 |                             |
| SCALE: 1" = NTS      | TRC:      |                     |                             |
| COUNTY: PRESQUE ISLE | TOWNSHIP: | CITY: ROGERS CITY   | PROJECT ID: LC017770FO37011 |
|                      |           |                     | CUSTOMER NUMBER: 017770     |

**HANDHOLE INSTALL**  
DETAIL

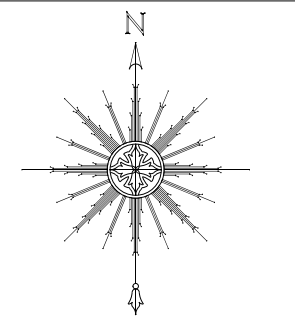
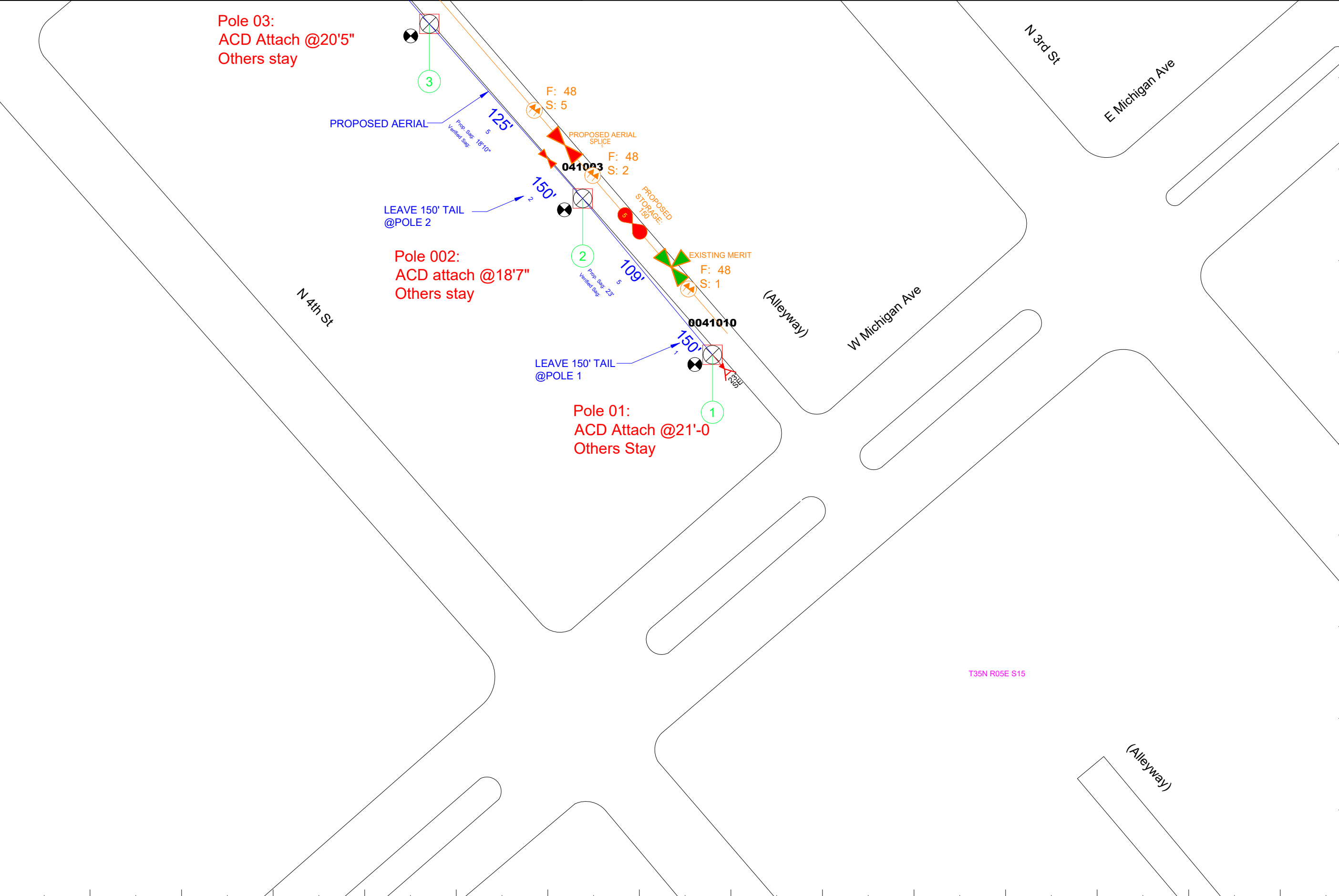

**ACD**<sub>NET</sub>  
 Advanced  
 Communications & Data  
 517-999-9999  
 1800 Grand River Ave  
 Lansing MI 48906

**PROPRIETARY**  
**INFORMATION NOT FOR DISCLOSURE**  
 This Set of Plans contains confidential or proprietary information, and the recipient must not disclose, copy, re-create, or distribute the plans or the information contained therein, either directly or indirectly, to other entities or individuals without written or express permission from ACD.NET

**DRAWING DISCLAIMER**  
 Facility Locations are general in nature, ACD.NET will not be held accountable for the accuracy of the information provided on these drawings. Contact the Local ONE CALL AGENCY 72 HOURS PRIOR TO CONSTRUCTION FOR EXACT UTILITY LOCATIONS AT:  
 MISS DIG: 1-800-482-7171 O.U.P.S.: 1-800-362-2764 INDIANA811: 1-800-382-5544  
 CAD Standard Ver. 72919

|                          |             |
|--------------------------|-------------|
| <b>Project Manager</b>   |             |
| T. BROWN                 |             |
| <b>Permitting</b>        |             |
| T. BROWN                 |             |
| <b>Transport Manager</b> |             |
| G. GOULD                 |             |
| <b>Drawn By</b>          | <b>Date</b> |
| J. ANDERSON              | 11/01/22    |
| <b>As Built</b>          | <b>Date</b> |
|                          |             |

| <b>Revisions</b> |             |    |      |
|------------------|-------------|----|------|
| REV #            | DESCRIPTION | BY | DATE |
|                  |             |    |      |
|                  |             |    |      |
|                  |             |    |      |
|                  |             |    |      |
|                  |             |    |      |
|                  |             |    |      |
|                  |             |    |      |
|                  |             |    |      |
|                  |             |    |      |
|                  |             |    |      |

**Exhibit:** N/A

|                      |                    |                   |                             |
|----------------------|--------------------|-------------------|-----------------------------|
| Remarks:             |                    |                   | PEACHTREE ID: 37011         |
| SCALE: 1" = 50'      | TRS: T35N R05E S15 |                   |                             |
| COUNTY: PRESQUE ISLE | TOWNSHIP:          | CITY: ROGERS CITY | PROJECT ID: LC017770FO37011 |
|                      |                    |                   | CUSTOMER NUMBER: 017770     |

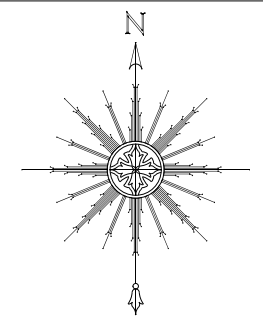
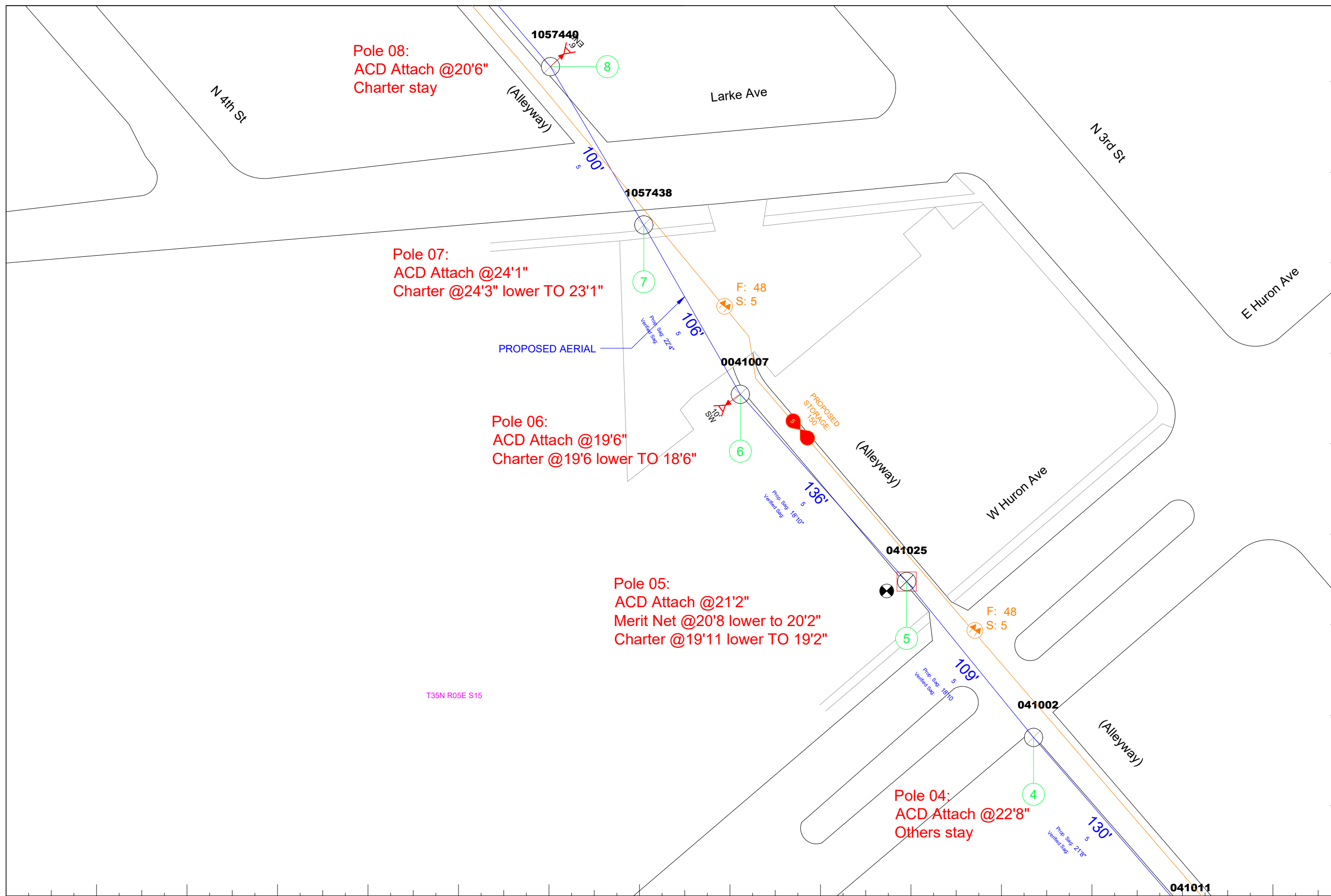

**ACD.NET**  
 Advanced  
 Communications & Data  
 517-999-9999  
 1800 Grand River Ave  
 Lansing MI 48906

**PROPRIETARY**  
**INFORMATION NOT FOR DISCLOSURE**  
 This Set of Plans contains confidential or proprietary information, and the recipient must not disclose, copy, re-create, or distribute the plans or the information contained therein, either directly or indirectly, to other entities or individuals without written or express permission from ACD.NET

**DRAWING DISCLAIMER**  
 Facility Locations are general in nature, ACD.NET will not be held accountable for the accuracy of the information provided on these drawings. Contact the Local ONE CALL AGENCY 72 HOURS PRIOR TO CONSTRUCTION FOR EXACT UTILITY LOCATIONS AT:  
 MISS DIG: 1-800-482-7171 O.U.P.S.: 1-800-362-2764 INDIANA811: 1-800-362-5544  
 CAD Standard Ver. 72919

**Project Manager**  
 T. BROWN  
**Permitting**  
 T. BROWN  
**Transport Manager**  
 G. GOULD

| Drawn By    | Date     |
|-------------|----------|
| J. ANDERSON | 11/01/22 |
| As Built    | Date     |
|             |          |

| Revisions |             |    |      |
|-----------|-------------|----|------|
| REV #     | DESCRIPTION | BY | DATE |
|           |             |    |      |
|           |             |    |      |
|           |             |    |      |
|           |             |    |      |
|           |             |    |      |
|           |             |    |      |
|           |             |    |      |
|           |             |    |      |
|           |             |    |      |
|           |             |    |      |

**Exhibit:** N/A

|                      |                    |                         |                             |
|----------------------|--------------------|-------------------------|-----------------------------|
| Remarks:             |                    | PEACHTREE ID: 37011     |                             |
| SCALE: 1" = 50'      | TRS: T35N R05E S15 |                         |                             |
| COUNTY: PRESQUE ISLE | TOWNSHIP:          | CITY: ROGERS CITY       | PROJECT ID: LC017770FO37011 |
|                      |                    | CUSTOMER NUMBER: 017770 |                             |

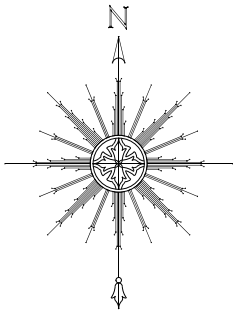

**ACD.NET**  
Advanced  
Communications & Data  
517-999-9999  
1800 Grand River Ave  
Lansing MI 48906

**PROPRIETARY**  
**INFORMATION NOT FOR DISCLOSURE**  
This Set of Plans contains confidential or proprietary information, and the recipient must not disclose, copy, re-create, or distribute the plans or the information contained therein, either directly or indirectly, to other entities or individuals without written or express permission from ACD.NET

**DRAWING DISCLAIMER**  
Facility Locations are general in nature, ACD.NET will not be held accountable for the accuracy of the information provided on these drawings. Contact the Local ONE CALL AGENCY 72 HOURS PRIOR TO CONSTRUCTION FOR EXACT UTILITY LOCATIONS AT:  
MISS DIG: 1-800-482-7171 O.U.P.S.: 1-800-362-2764 INDIANA811: 1-800-382-5544  
CAD Standard Ver. 72919

**Project Manager**  
T. BROWN  
**Permitting**  
T. BROWN  
**Transport Manager**  
G. GOULD

| Drawn By    | Date     |
|-------------|----------|
| J. ANDERSON | 11/01/22 |
| As Built    | Date     |
|             |          |

| Revisions |             |    |      |
|-----------|-------------|----|------|
| REV #     | DESCRIPTION | BY | DATE |
|           |             |    |      |
|           |             |    |      |
|           |             |    |      |
|           |             |    |      |
|           |             |    |      |
|           |             |    |      |
|           |             |    |      |
|           |             |    |      |
|           |             |    |      |
|           |             |    |      |
|           |             |    |      |
|           |             |    |      |
|           |             |    |      |
|           |             |    |      |
|           |             |    |      |
|           |             |    |      |
|           |             |    |      |
|           |             |    |      |
|           |             |    |      |
|           |             |    |      |
|           |             |    |      |
|           |             |    |      |

**Exhibit:** N/A

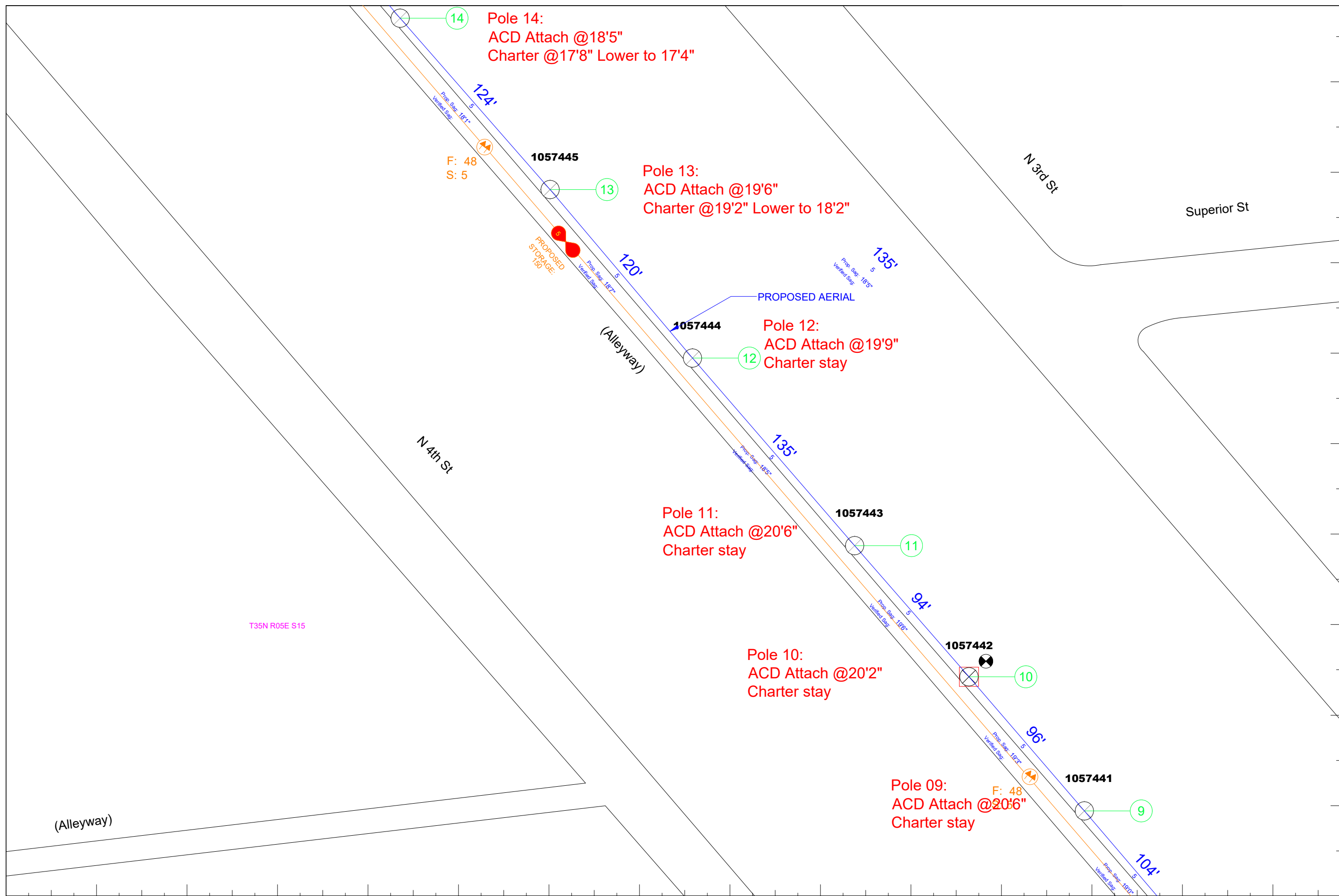

|                      |                     |                   |                             |
|----------------------|---------------------|-------------------|-----------------------------|
| Remarks:             | PEACHTREE ID: 37011 |                   |                             |
| SCALE: 1" = 50'      | TRS: T35N R05E S15  |                   |                             |
| COUNTY: PRESQUE ISLE | TOWNSHIP:           | CITY: ROGERS CITY | PROJECT ID: LC017770FO37011 |
|                      |                     |                   | CUSTOMER NUMBER: 017770     |



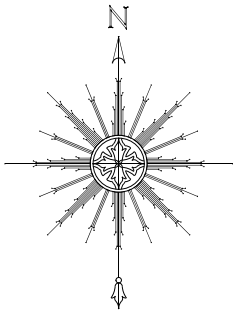

Communications & Data  
517-999-9999  
1800 Grand River Ave  
Lansing MI 48906

**PROPRIETARY  
INFORMATION NOT FOR  
DISCLOSURE**

This Set of Plans contains confidential or proprietary information, and the recipient must not disclose, copy, re-create, or distribute the plans or the information contained therein, either directly or indirectly, to other entities or individuals without written or express permission from ACD.NET

**DRAWING DISCLAIMER**

Facility Locations are general in nature, ACD.NET will not be held accountable for the accuracy of the information provided on these drawings. Contact the Local ONE CALL AGENCY 72 HOURS PRIOR TO CONSTRUCTION FOR EXACT UTILITY LOCATIONS AT:

|                            |                            |                              |
|----------------------------|----------------------------|------------------------------|
| MISS DIG<br>1-800-482-7171 | O.U.P.S.<br>1-800-362-2764 | INDIANA811<br>1-800-382-5544 |
|----------------------------|----------------------------|------------------------------|

CAD Standard Ver. 72919

**Project Manager**

T. BROWN

**Permitting**

T. BROWN

**Transport Manager**

G. GOULD

**Drawn By**

**Date**

J. ANDERSON

11/01/22

**As Built**

**Date**

**Revisions**

| REV # | DESCRIPTION | BY | DATE |
|-------|-------------|----|------|
|       |             |    |      |
|       |             |    |      |
|       |             |    |      |
|       |             |    |      |
|       |             |    |      |
|       |             |    |      |
|       |             |    |      |
|       |             |    |      |
|       |             |    |      |
|       |             |    |      |
|       |             |    |      |
|       |             |    |      |
|       |             |    |      |
|       |             |    |      |
|       |             |    |      |
|       |             |    |      |
|       |             |    |      |
|       |             |    |      |

**Exhibit:** N/A

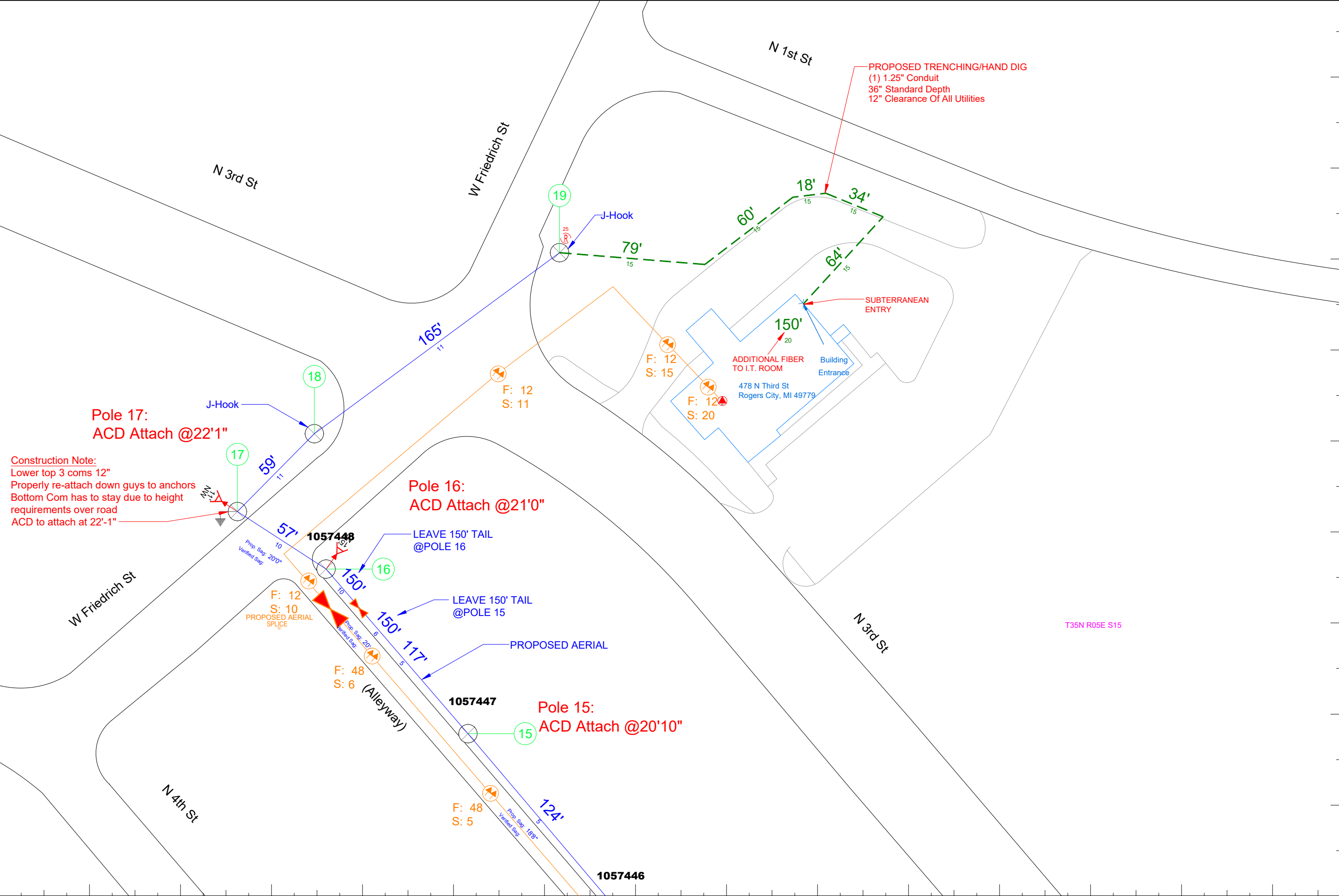

|                      |                    |                         |                             |
|----------------------|--------------------|-------------------------|-----------------------------|
| Remarks:             |                    | PEACHTREE ID: 37011     |                             |
| SCALE: 1" = 50'      | TRS: T35N R05E S15 |                         |                             |
| COUNTY: PRESQUE ISLE | TOWNSHIP:          | CITY: ROGERS CITY       | PROJECT ID: LC017770FO37011 |
|                      |                    | CUSTOMER NUMBER: 017770 |                             |