



Communications & Data

KEPS Technologies, Inc. d/b/a ACD.net
FIBER OPTIC CABLE ROUTE

Project Number
LC017635FO36508

[517-999-9999](tel:517-999-9999)

1800 Grand River Ave
Lansing MI 48906

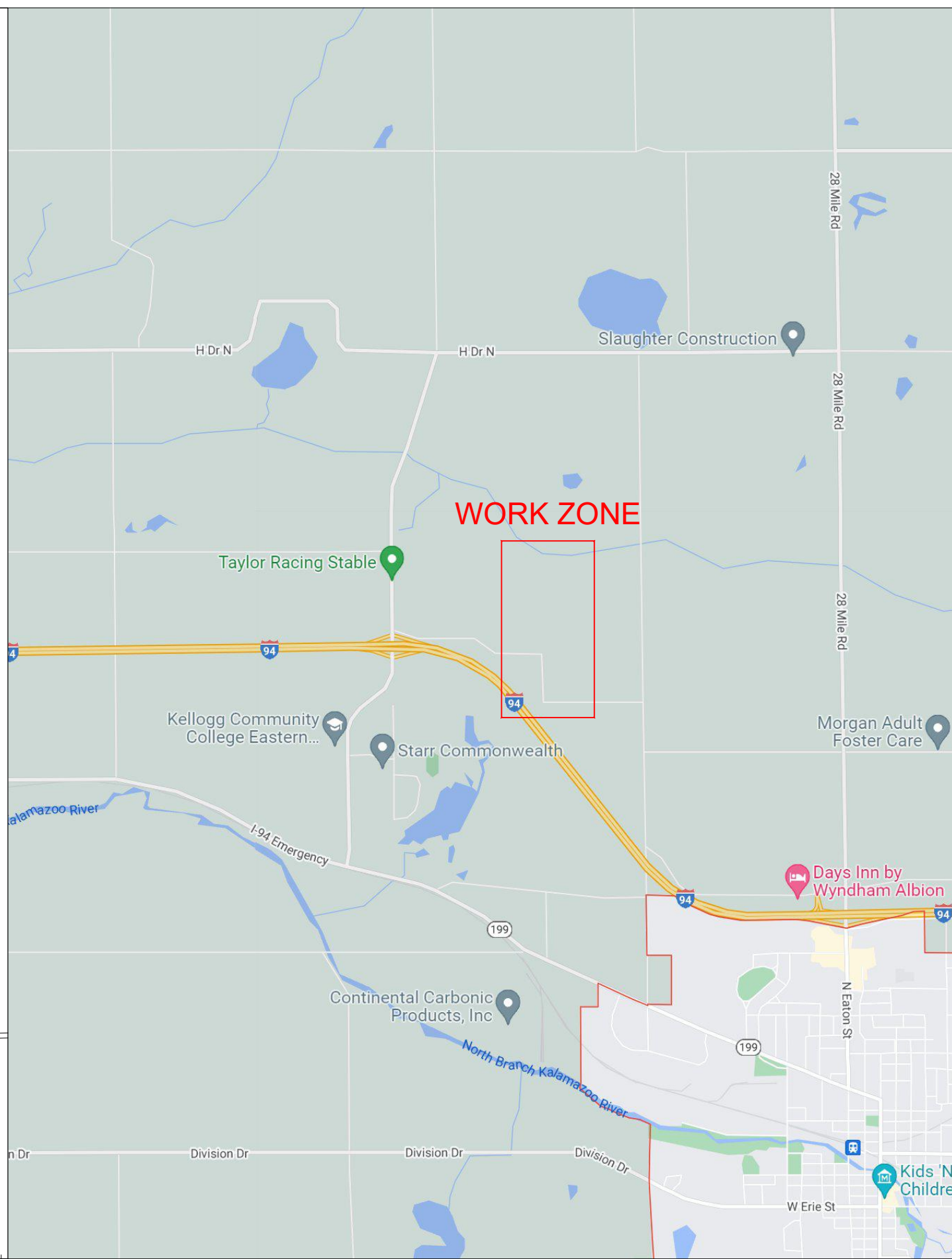
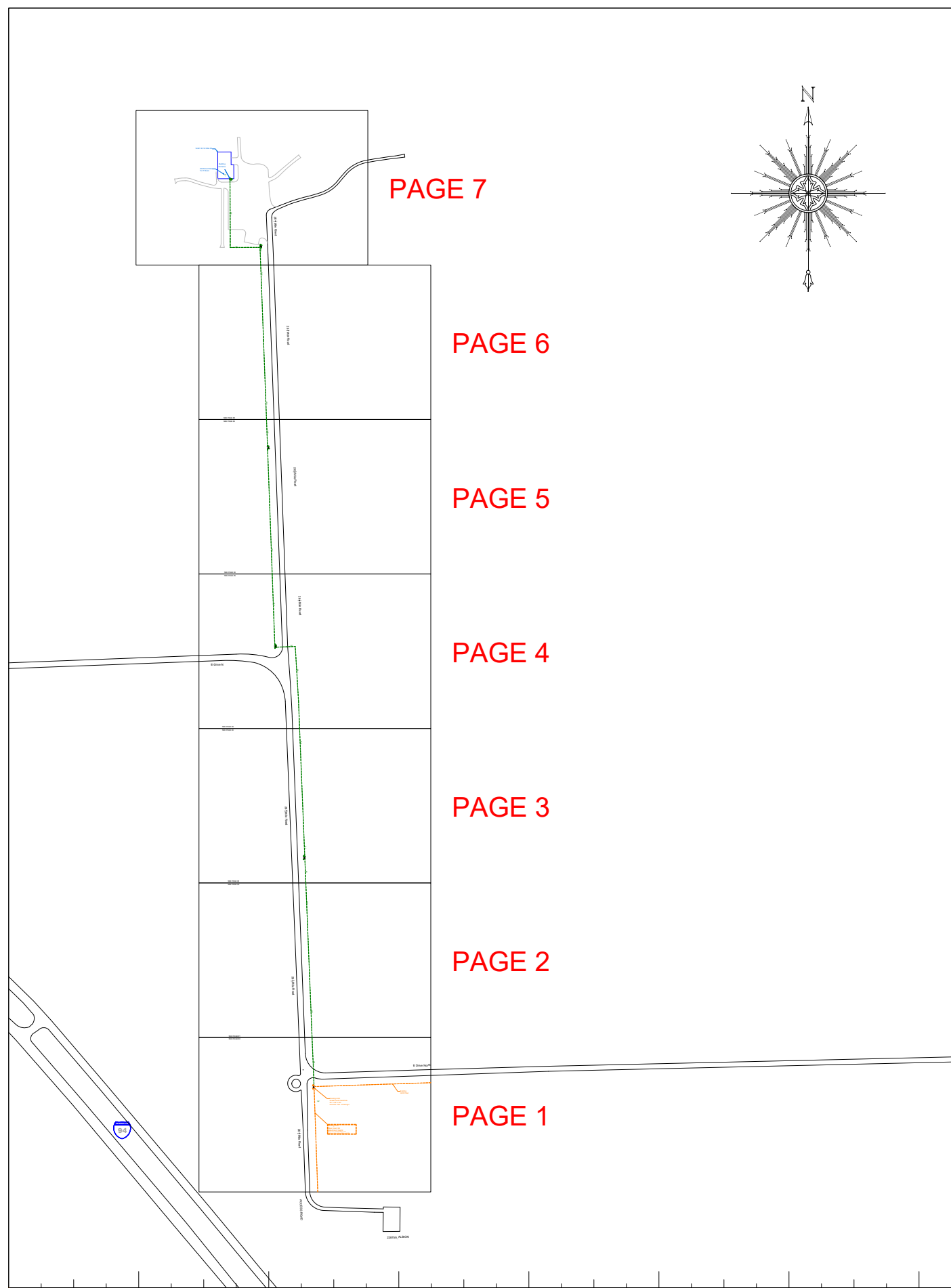

ACD.NET
Advanced
Communications & Data
517-999-9999
1800 Grand River Ave
Lansing MI 48906

PROPRIETARY
INFORMATION NOT FOR DISCLOSURE
This Set of Plans contains confidential or proprietary information, and the recipient must not disclose, copy, re-create, or distribute the plans or the information contained therein, either directly or indirectly, to other entities or individuals without written or express permission from ACD.NET

DRAWING DISCLAIMER
Facility Locations are general in nature, ACD.NET will not be held accountable for the accuracy of the information provided on these drawings. Contact the Local ONE CALL AGENCY 72 HOURS PRIOR TO CONSTRUCTION FOR EXACT UTILITY LOCATIONS AT:

MISS DIG	O.U.P.S.	INDIANA811
1-800-482-7171	1-800-362-2764	1-800-382-5544

CAD Standard Ver. 72919

Project Manager
A. Heald

Permitting
A. Heald

Transport Manager
G. Gould

Drawn By	Date
K. Ngo	5/20/22

As Built	Date

Revisions			
REV #	DESCRIPTION	BY	DATE

Exhibit: N/A

Remarks:		PEACHTREE ID: 36508	
SCALE: 1" = NTS	TRIS:		
COUNTY: Calhoun	TOWNSHIP: Sheridan	CITY:	PROJECT ID: LC017635FO36508
			CUSTOMER NUMBER: 17635

Proposed Anchor Distance and Direction	Reg Sidewalk 	Fiber Count W/ Segment Number 	Man Hole 	Typical Line Types
Proposed ACD Communications Poles		Fiber Termination Point 	Storm Drain 	
Proposed ACD NON Communications Pole		ACD Splice Case Six Way 	ACD Regen Cabinet 	
Colocation Poles (ACD Communication Equipment on Existing Poles)		ACD Splice Case Four Way 	TRS Section Corner 	
Joint Use Pole NON Transformer		ACD Splice Case Three Way 	Fire Hydrant 	
Joint Use Pole Transformer		ACD Splice Case Two Way 	Location Address 	
Foreign Pole Indicator		ACD Fiber Tap Capsule 	Foliage 	
Joint Use Pole NON Transformer- UNUSED		ACD RE-Box 	Centerline Marker 	
Joint Use Pole Transformer- UNUSED		Foreign Splice Case 	Station Marker 	
Street Light		Storage Loop w/ Footage and Segment 	Use of Double Dead End 	
Existing Traffic Signal Pole		ACD Buried Cable Marker 		
Pole Number Marker		ACD Hand Hole 17" x 12" 		
Proposed Riser		ACD Hand Hole 24" x 13" 		
Make Ready Symbol w/ Attachment and Sag Heights		ACD Hand Hole 24" x 36" 		
Down Ground		ACD Hand Hole 30" x 48" 		
Bonding Clamp		Foreign Hand Hole 		
Fiber Overlash		Proposed Bore Pit Location 	Bore Pit (size)	
Overhead Guy Marker		Communications Tower 		
Span Length and Segment ID				

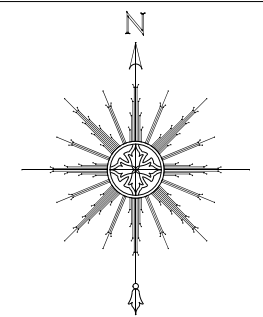

ACD_{NET}
Advanced
Communications & Data
517-999-9999
1800 Grand River Ave
Lansing MI 48906

PROPRIETARY
INFORMATION NOT FOR DISCLOSURE
This Set of Plans contains confidential or proprietary information, and the recipient must not disclose, copy, re-create, or distribute the plans or the information contained therein, either directly or indirectly, to other entities or individuals without written or express permission from ACD.NET

DRAWING DISCLAIMER
Facility Locations are general in nature, ACD.NET will not be held accountable for the accuracy of the information provided on these drawings. Contact the Local ONE CALL AGENCY 72 HOURS PRIOR TO CONSTRUCTION FOR EXACT UTILITY LOCATIONS AT:

MISS DIG	O.U.P.S	INDIANA811
1-800-482-7171	1-800-362-2764	1-800-382-5544

 CAD Standard Ver. 72919

Project Manager	
A. Heald	
Permitting	
A. Heald	
Transport Manager	
G. Gould	
Drawn By	Date
K. Ngo	5/20/22
As Built	Date

Revisions			
REV #	DESCRIPTION	BY	DATE

Our Match Lines can be found in the lower right hand corner and represents the neighboring page numbers.

WEST PAGE	NORTH PAGE	EAST PAGE
	PAGE	
	SOUTH PAGE	

Remarks:			PEACHTREE ID: 36508		
SCALE: 1" = NTS	TRRS:				
COUNTY: Calhoun	TOWNSHIP: Sheridan	CITY:	PROJECT ID: LC017635FO36508	CUSTOMER NUMBER: 17635	

Exhibit: N/A

SYMBOLS
LEGEND

T2S R4W S21

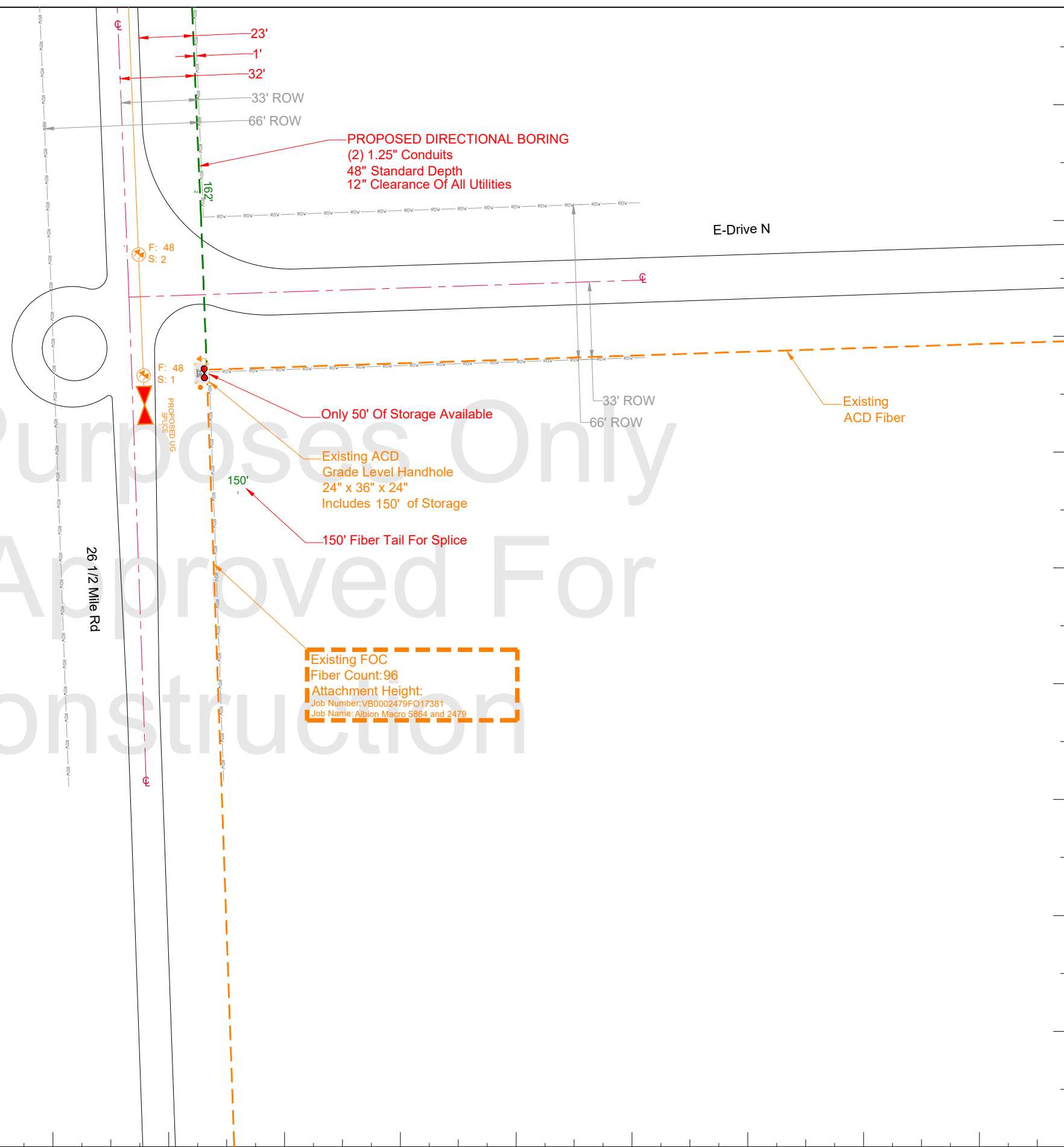

Bid Purposes Only
Not Approved For
Construction

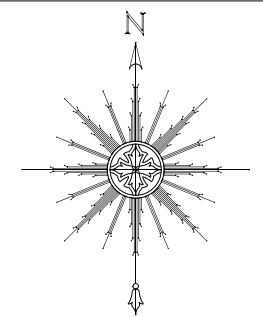

ACD_{NET}
Advanced
Communications & Data
517-999-9999
1800 Grand River Ave
Lansing MI 48906

PROPRIETARY
INFORMATION NOT FOR DISCLOSURE
This Set of Plans contains confidential or proprietary information, and the recipient must not disclose, copy, re-create, or distribute the plans or the information contained therein, either directly or indirectly, to other entities or individuals without written or express permission from ACD.NET

DRAWING DISCLAIMER
Facility Locations are general in nature, ACD.NET will not be held accountable for the accuracy of the information provided on these drawings. Contact the Local ONE CALL AGENCY 72 HOURS PRIOR TO CONSTRUCTION FOR EXACT UTILITY LOCATIONS AT:
MISS DIG 1-800-482-7171 O.U.P.S. 1-800-362-2764 INDIANA811 1-800-382-5544
CAD Standard Ver. 72919

Project Manager	
A. Heald	
Permitting	
A. Heald	
Transport Manager	
G. Gould	
Drawn By	Date
K. Ngo	5/20/22
As Built	Date

Revisions			
REV #	DESCRIPTION	BY	DATE

Exhibit: N/A

Remarks:			PEACHTREE ID: 36508	
SCALE: 1" = 50'	TRS: T2S R4W S21			
COUNTY: Calhoun	TOWNSHIP: Sheridan	CITY:	PROJECT ID: LC017635FO36508	CUSTOMER NUMBER: 17635

T2S R4W S21

Bid Purposes Only
Not Approved For
Construction

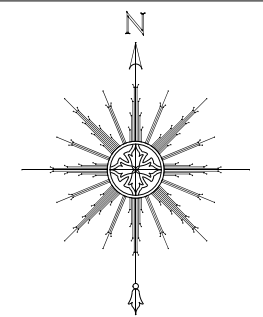
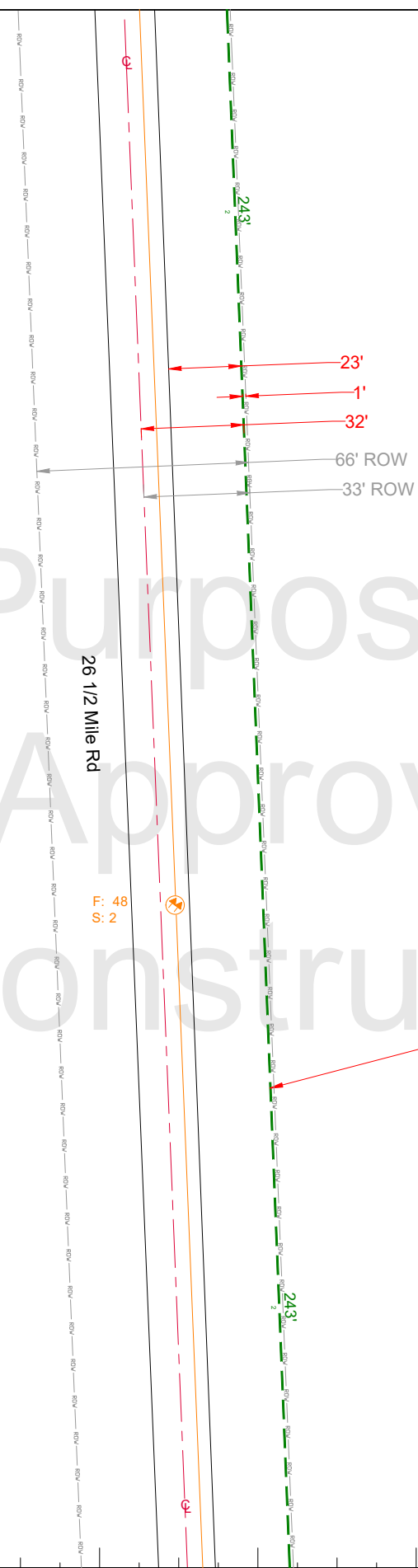

ACD_{NET}
Advanced
Communications & Data
517-999-9999
1800 Grand River Ave
Lansing MI 48906

PROPRIETARY
INFORMATION NOT FOR DISCLOSURE
This Set of Plans contains confidential or proprietary information, and the recipient must not disclose, copy, re-create, or distribute the plans or the information contained therein, either directly or indirectly, to other entities or individuals without written or express permission from ACD.NET

DRAWING DISCLAIMER
Facility Locations are general in nature, ACD.NET will not be held accountable for the accuracy of the information provided on these drawings. Contact the Local ONE CALL AGENCY 72 HOURS PRIOR TO CONSTRUCTION FOR EXACT UTILITY LOCATIONS AT:
MISS DIG 1-800-482-7171 O.U.P.S. 1-800-362-2764 INDIANA811 1-800-382-5544
CAD Standard Ver. 72919

Project Manager

A. Heald

Permitting

A. Heald

Transport Manager

G. Gould

Drawn By	Date
K. Ngo	5/20/22

As Built	Date

Revisions

REV #	DESCRIPTION	BY	DATE

Exhibit: N/A

Remarks:			PEACHTREE ID: 36508	
SCALE: 1" = 50'	TRS: T2S R4W S21			
COUNTY: Calhoun	TOWNSHIP: Sheridan	CITY:	PROJECT ID: LC017635FO36508	CUSTOMER NUMBER: 17635

T2S R4W S21

Bid Purposes Only
Not Approved For
Construction

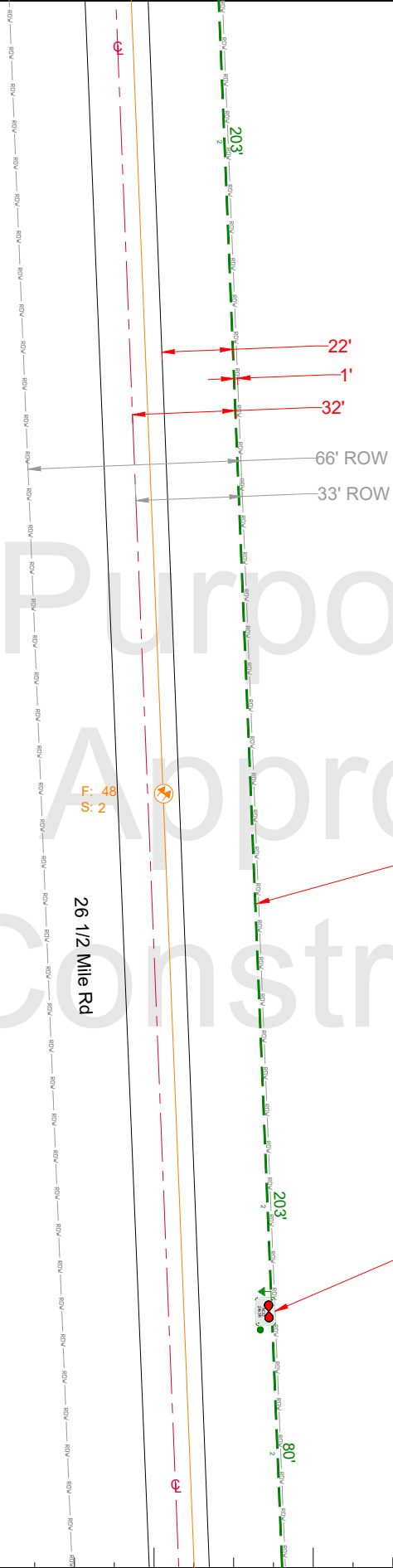

PROPOSED DIRECTIONAL BORING
(2) 1.25" Conduits
48" Standard Depth
12" Clearance Of All Utilities

Proposed ACD
Grade Level Handhole
24" x 36" x 24"
Includes 150' of Storage
See Handhole Installation Detail Page

F: 48
S: 2

26 1/2 Mile Rd

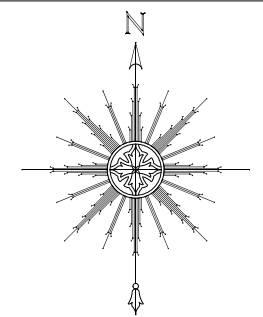

ACD.NET
Advanced
Communications & Data
517-999-9999
1800 Grand River Ave
Lansing MI 48906

PROPRIETARY
INFORMATION NOT FOR DISCLOSURE
This Set of Plans contains confidential or proprietary information, and the recipient must not disclose, copy, re-create, or distribute the plans or the information contained therein, either directly or indirectly, to other entities or individuals without written or express permission from ACD.NET

DRAWING DISCLAIMER
Facility Locations are general in nature, ACD.NET will not be held accountable for the accuracy of the information provided on these drawings. Contact the Local ONE CALL AGENCY 72 HOURS PRIOR TO CONSTRUCTION FOR EXACT UTILITY LOCATIONS AT:
MISS DIG 1-800-482-7171 O.U.P.S. 1-800-362-2764 INDIANA811 1-800-382-5544
CAD Standard Ver. 72919

Project Manager	
A. Heald	
Permitting	
A. Heald	
Transport Manager	
G. Gould	
Drawn By	Date
K. Ngo	5/20/22
As Built	Date

Revisions			
REV #	DESCRIPTION	BY	DATE

Exhibit: N/A

Remarks:			PEACHTREE ID: 36508	
SCALE: 1" = 50'	TRS: T2S R4W S21			
COUNTY: Calhoun	TOWNSHIP: Sheridan	CITY:	PROJECT ID: LC017635FO36508	CUSTOMER NUMBER: 17635

SEE PAGE #5

PROPOSED DIRECTIONAL BORING
 (2) 1.25" Conduits
 48" Standard Depth
 12" Clearance Of All Utilities

T2S R4W S21

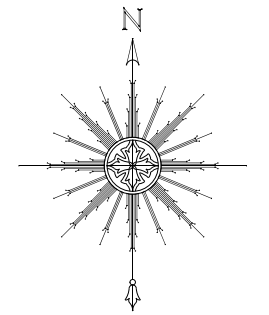

Communications & Data
 517-999-9999
 1800 Grand River Ave
 Lansing MI 48906

PROPRIETARY
INFORMATION NOT FOR DISCLOSURE

This Set of Plans contains confidential or proprietary information, and the recipient must not disclose, copy, re-create, or distribute the plans or the information contained therein, either directly or indirectly, to other entities or individuals without written or express permission from ACD.NET

DRAWING DISCLAIMER

Facility Locations are general in nature, ACD.NET will not be held accountable for the accuracy of the information provided on these drawings. Contact the Local ONE CALL AGENCY 72 HOURS PRIOR TO CONSTRUCTION FOR EXACT UTILITY LOCATIONS AT:

MISS DIG 1-800-482-7171	O.U.P.S. 1-800-362-2764	INDIANA811 1-800-382-5544
----------------------------	----------------------------	------------------------------

CAD Standard Ver. 72919

Project Manager

A. Heald

Permitting

A. Heald

Transport Manager

G. Gould

Drawn By	Date
K. Ngo	5/20/22

As Built	Date

Revisions

REV #	DESCRIPTION	BY	DATE

Exhibit: N/A

Bid Purposes Only
Not Approved For
Construction

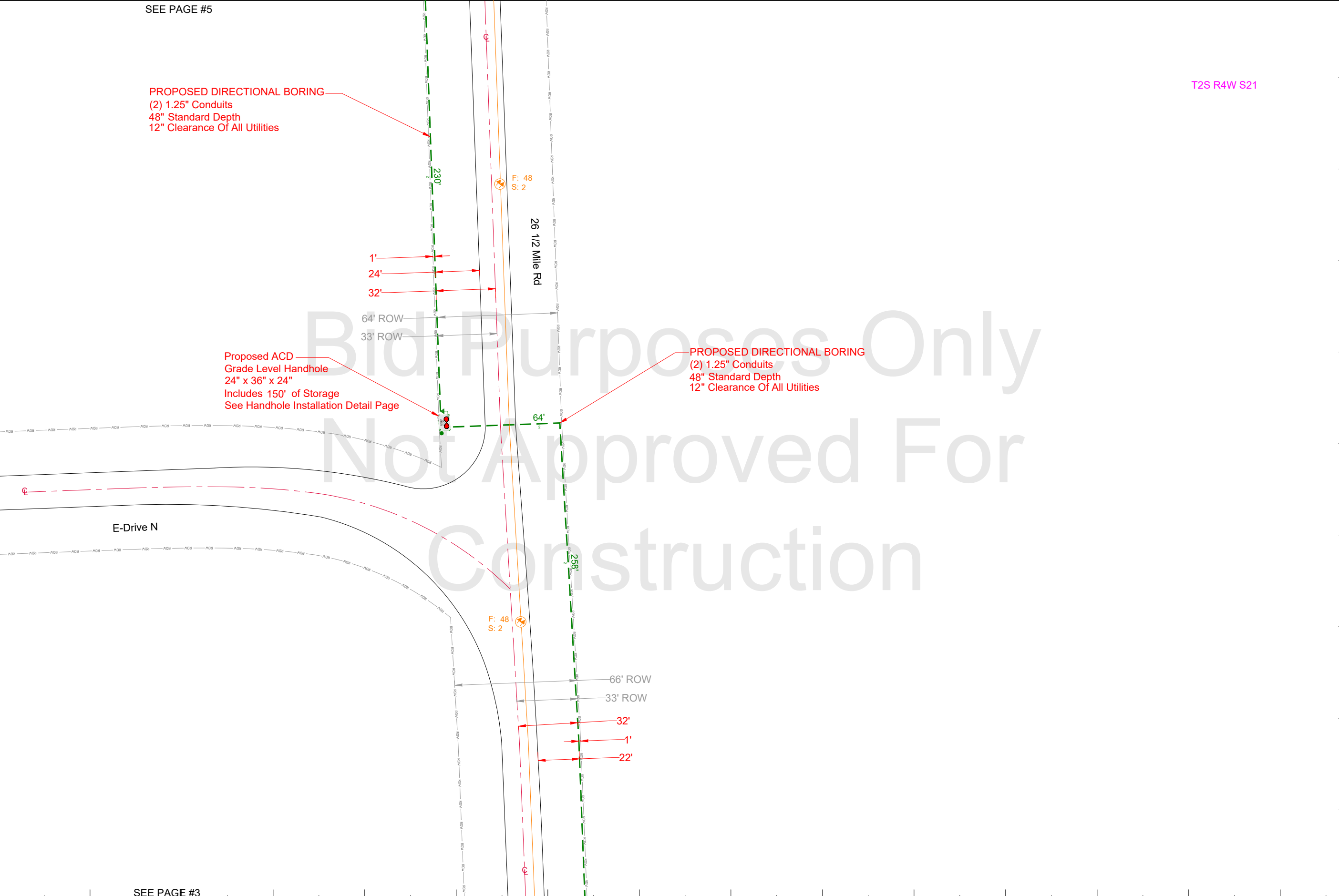

SEE PAGE #3

Remarks: PEACHTREE ID: 36508

SCALE: 1" = 50' TRS: T2S R4W S21

COUNTY: Calhoun TOWNSHIP: Sheridan CITY: PROJECT ID: LC017635FO36508 CUSTOMER NUMBER: 17635

PAGE 4

SEE PAGE #4

T2S R4W S21

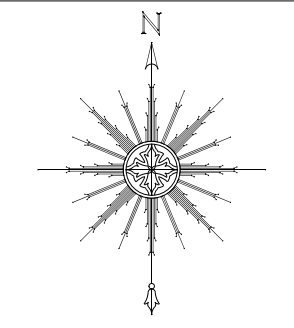

ACD_{NET}
 Advanced
 Communications & Data
 517-999-9999
 1800 Grand River Ave
 Lansing MI 48906

PROPRIETARY
INFORMATION NOT FOR DISCLOSURE

This Set of Plans contains confidential or proprietary information, and the recipient must not disclose, copy, re-create, or distribute the plans or the information contained therein, either directly or indirectly, to other entities or individuals without written or express permission from ACD.NET

DRAWING DISCLAIMER

Facility Locations are general in nature, ACD.NET will not be held accountable for the accuracy of the information provided on these drawings. Contact the Local ONE CALL AGENCY 72 HOURS PRIOR TO CONSTRUCTION FOR EXACT UTILITY LOCATIONS AT:

MISS DIG 1-800-482-7171	O.U.P.S. 1-800-362-2764	INDIANA811 1-800-382-5544
----------------------------	----------------------------	------------------------------

CAD Standard Ver. 72919

Project Manager

A. Heald

Permitting

A. Heald

Transport Manager

G. Gould

Drawn By Date

K. Ngo 5/20/22

As Built Date

Revisions

REV #	DESCRIPTION	BY	DATE

Exhibit: N/A

Proposed ACD
 Grade Level Handhole
 24" x 36" x 24"
 Includes 150' of Storage
 See Handhole Installation Detail Page

PROPOSED DIRECTIONAL BORING
 (2) 1.25" Conduits
 48" Standard Depth
 12" Clearance Of All Utilities

Bid Purposes Only
 Not Approved For
 Construction

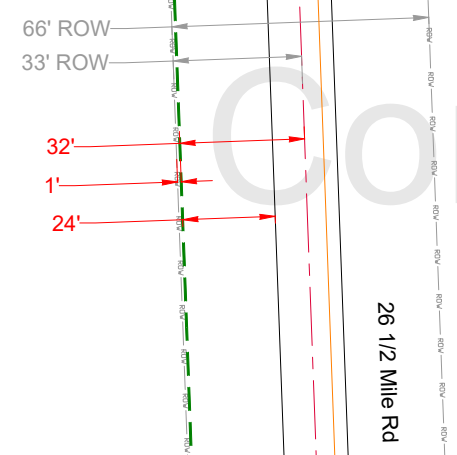

F: 48
S: 2

SEE PAGE #4

Remarks:			PEACHTREE ID: 36508	
SCALE: 1" = 50'	TRS: T2S R4W S21			
COUNTY: Calhoun	TOWNSHIP: Sheridan	CITY:	PROJECT ID: LC017635FO36508	CUSTOMER NUMBER: 17635

T2S R4W S21

PROPOSED DIRECTIONAL BORING
(2) 1.25" Conduits
48" Standard Depth
12" Clearance Of All Utilities

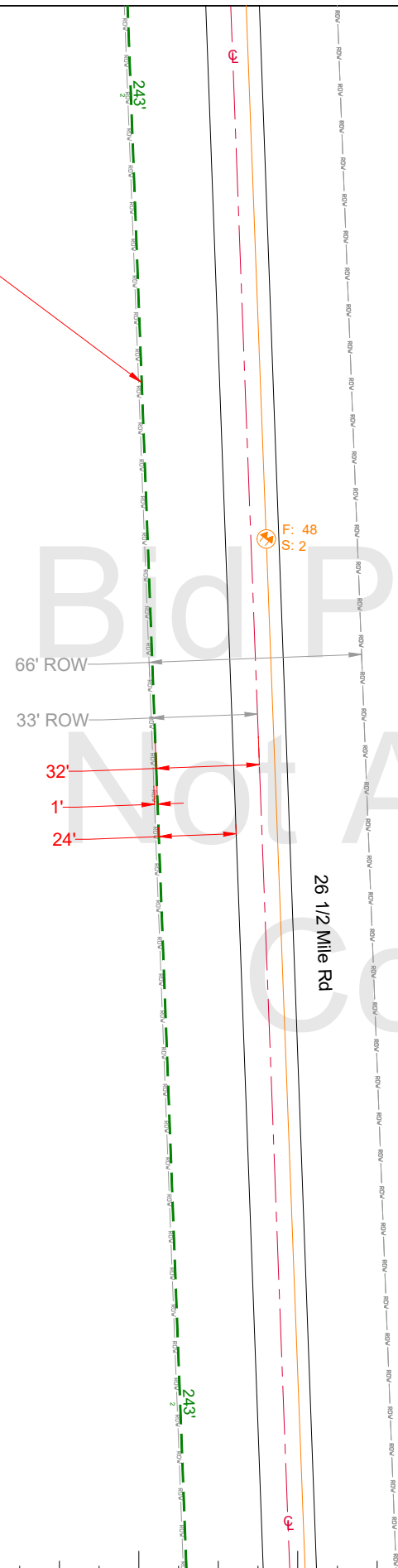

Bid Purposes Only
Not Approved For Construction

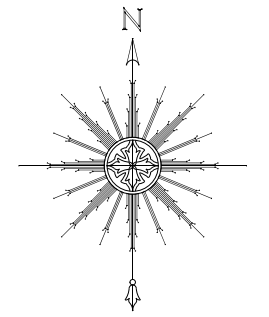

517-999-9999
1800 Grand River Ave
Lansing MI 48906

**PROPRIETARY
INFORMATION NOT FOR
DISCLOSURE**

This Set of Plans contains confidential or proprietary information, and the recipient must not disclose, copy, re-create, or distribute the plans or the information contained therein, either directly or indirectly, to other entities or individuals without written or express permission from ACD.NET

DRAWING DISCLAIMER

Facility Locations are general in nature, ACD.NET will not be held accountable for the accuracy of the information provided on these drawings. Contact the Local ONE CALL AGENCY 72 HOURS PRIOR TO CONSTRUCTION FOR EXACT UTILITY LOCATIONS AT:

MISS DIG 1-800-482-7171	O.U.P.S. 1-800-362-2764	INDIANA811 1-800-382-5544
----------------------------	----------------------------	------------------------------

CAD Standard Ver. 72919

Project Manager

A. Heald

Permitting

A. Heald

Transport Manager

G. Gould

Drawn By Date

K. Ngo 5/20/22

As Built Date

Revisions

REV #	DESCRIPTION	BY	DATE

Exhibit: N/A

SEE PAGE #5

Remarks:	PEACHTREE ID: 36508
SCALE: 1" = 50'	TRS: T2S R4W S21
COUNTY: Calhoun	TOWNSHIP: Sheridan
CITY:	PROJECT ID: LC017635FO36508
	CUSTOMER NUMBER: 17635

