



Advanced Communications & Data

**KEPS Technologies, Inc. d/b/a ACD.net**  
**FIBER OPTIC CABLE ROUTE**

Project Number  
**LC017297FO035823**

[517-999-9999](tel:517-999-9999)

1800 Grand River Ave  
Lansing MI 48906

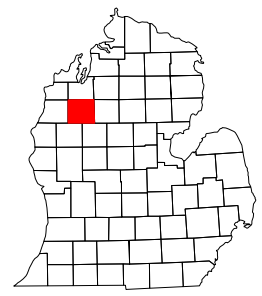
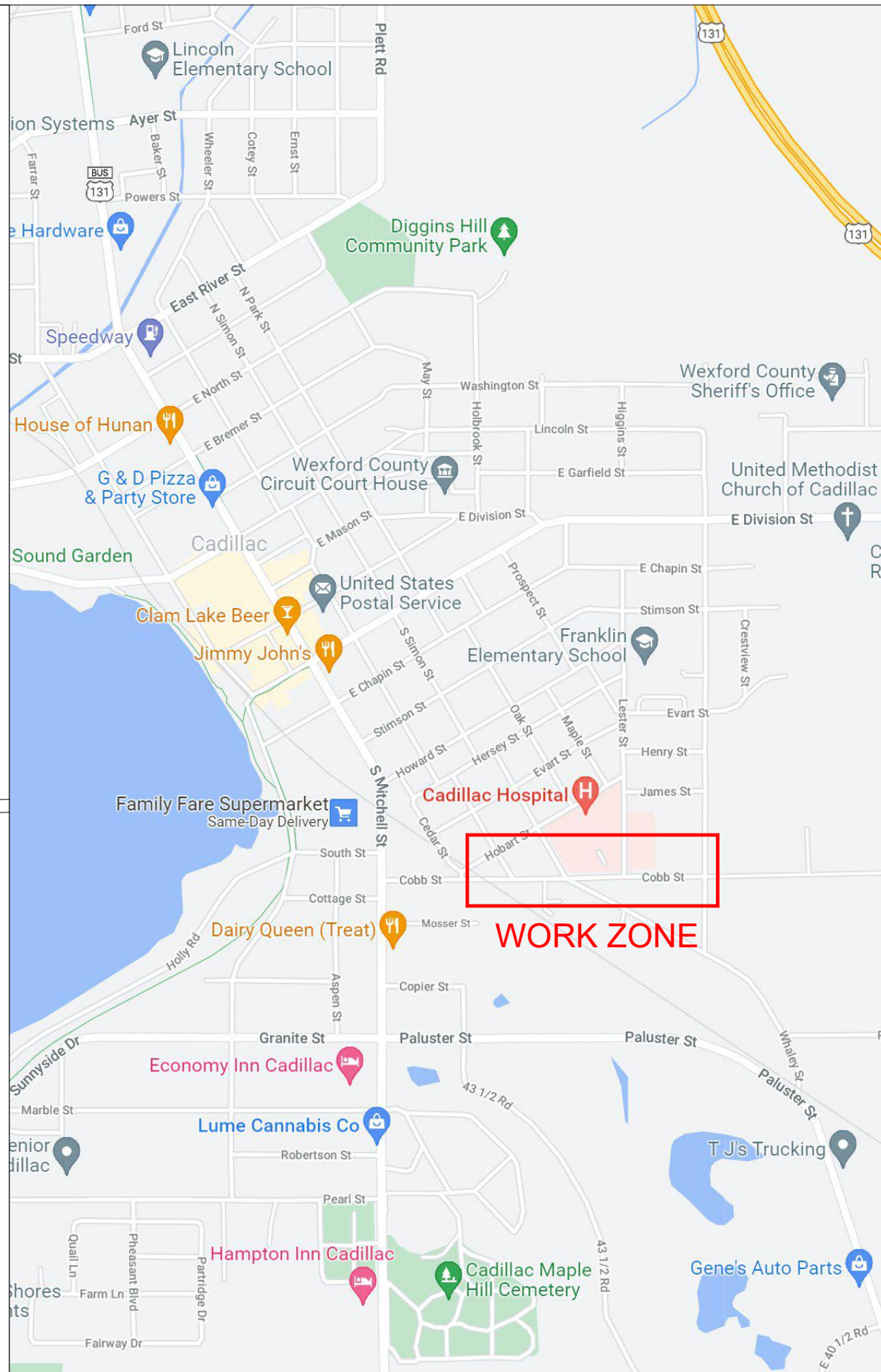
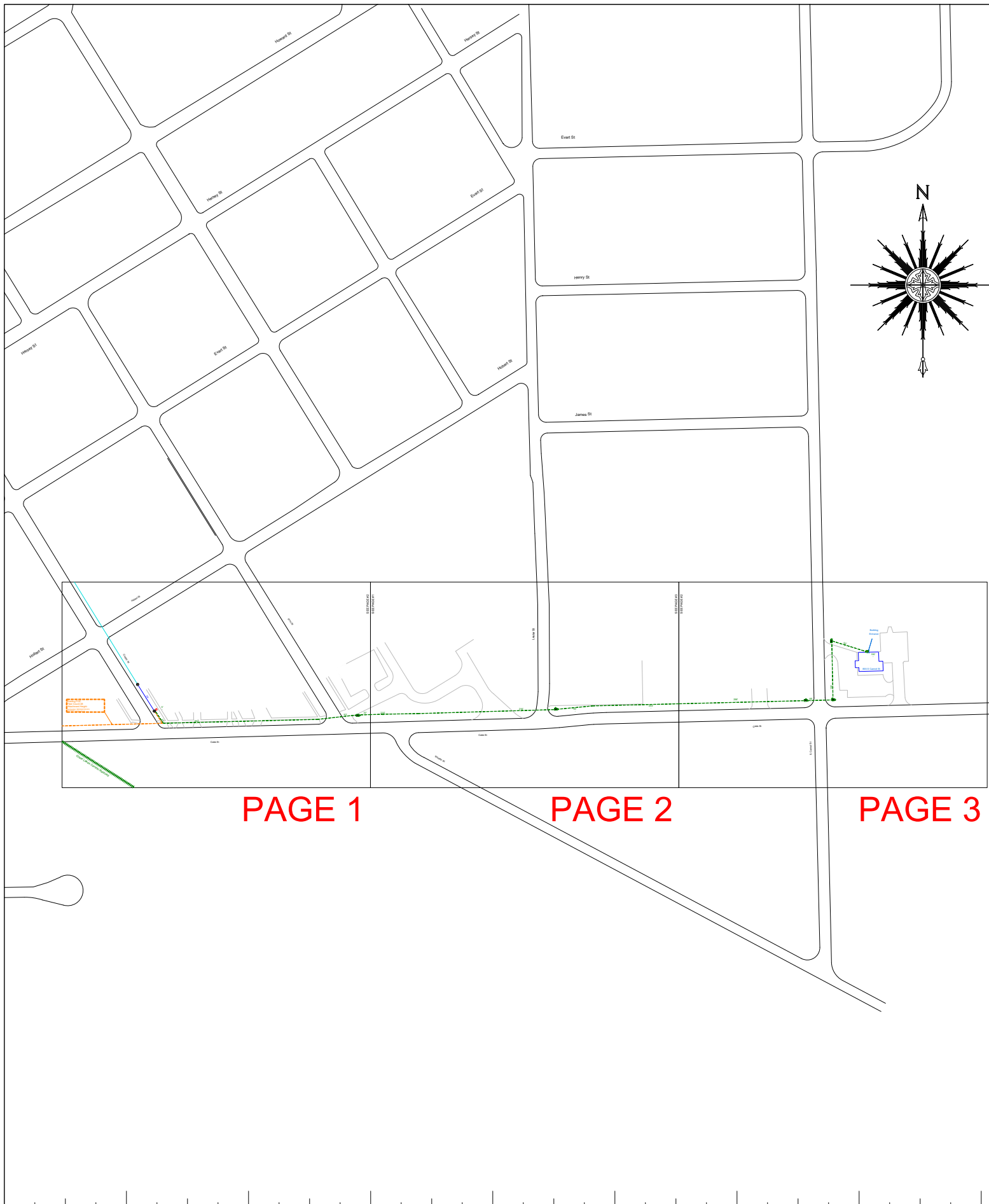

**ACD.NET**  
Advanced Communications & Data

517-999-9999  
1800 Grand River Ave  
Lansing MI 48906

**PROPRIETARY INFORMATION NOT FOR DISCLOSURE**  
This Set of Plans contains confidential or proprietary information, and the recipient must not disclose, copy, re-create, or distribute the plans or the information contained therein, either directly or indirectly, to other entities or individuals without written or express permission from ACD.NET

**DRAWING DISCLAIMER**  
Facility Locations are general in nature, ACD.NET will not be held accountable for the accuracy of the information provided on these drawings. Contact the Local ONE CALL AGENCY 72 HOURS PRIOR TO CONSTRUCTION FOR EXACT UTILITY LOCATIONS AT:  
MISS DIG 1-800-482-7171 O.U.P.S. 1-800-362-2764 INDIANA811 1-800-382-5544  
CAD Standard Ver. 72919

**Project Manager**

P. Gray

**Permitting**

P. Gray

**Transport Manager**

G. Gould

**Drawn By** K. Ngo **Date** 2/14/22

**As Built** **Date**

**Revisions**

| REV # | DESCRIPTION  | BY  | DATE    |
|-------|--|-----|---------|
| 1     | Added Handholes  | KN  | 3/14/22 |
| 2     | Fixed Dim, changed main run to (2) conduit and drop to bldg to (1) conduit | DTW | 4-26-22 |
|       |  |     |         |
|       |  |     |         |
|       |  |     |         |
|       |  |     |         |
|       |  |     |         |
|       |  |     |         |

**Exhibit:** N/A

|                 |           |                |                              |                        |  |
|-----------------|-----------|----------------|------------------------------|------------------------|--|
| Remarks:        |           |                |                              | PEACHTREE ID:          |  |
| SCALE: 1" = NTS |           | TRS:           |                              | GRID KEY               |  |
| COUNTY: Wexford | TOWNSHIP: | CITY: Cadillac | PROJECT ID: LC017297FO035823 | CUSTOMER NUMBER: 17297 |  |

**CONSTRUCTION NOTES**

1. CONTRACTOR SHALL EMAIL \_\_GRAY.PAMELA@ACD.NET\_\_ WITH DAILY STATUS UPDATES AND ONCE WORK IS COMPLETE
2. MUNICIPALITY MUST BE NOTIFIED AT LEAST 48 HOURS BEFORE ANY WORK COMMENCES
3. ALL APPROPRIATE PERMITS AND ASSOCIATED DRAWINGS SHALL BE ON-SITE AT ALL TIMES DURING CONSTRUCTION
4. NOTIFY THE APPROPRIATE UTILITY NOTIFICATION SERVICE 72 HOURS PRIOR TO CONSTRUCTION.  
MICHIGAN- MISS DIG (1-800-482-1711), OHIO- O.U.P.S. (1-800-362-2764) OR INDIANA- INDIANA811 (1-800-382-5544)
5. ALL UTILITIES MUST BE FIELD VERIFIED
6. ALL HANDHOLES ARE TO INCLUDE 150' OF COILED FIBER FOR STORAGE
7. NEW INSTALLATION SHALL MAINTAIN 18" CLEARANCE FROM ALL EXISTING UTILITIES UNLESS NOTED OTHERWISE
8. ALL ROAD AND DRIVEWAY CROSSINGS WILL BE DIRECTIONAL BORED
9. CONSTRUCTION SHALL NOT DEVIATE FROM APPROVED PLANS WITHOUT WRITTEN CONSENT FROM BOTH THE MUNICIPALITY AND AN AUTHORIZED ACD.NET REPRESENTATIVE
10. PROPER SIGNAGE AND TRAFFIC CONTROL IS REQUIRED BEFORE STARTING ANY WORK WITHIN THE PUBLIC RIGHT OF WAY
11. ALL BACKFILL MATERIAL WITHIN THE ROAD RIGHT OF WAY OR NEAR SIDEWALKS AND PATHWAYS SHALL MEET THE REQUIREMENTS OF MDOT CLASS II MATERIAL, COMPACTED TO 95% OF ITS MAXIMUM DENSITY IN SUCCESSIVE LAYERS THAT ARE NO MORE THAN 12" THICK, UNLESS OTHERWISE AUTHORIZED
12. ALL SODDED AREAS THAT MAY DISTURBED DURING CONSTRUCTION ARE TO BE RESTORED WITH 3" QUALITY TOP SOIL, SEED AND MULCH
13. CONTRACTOR SHALL PROVIDE AS-BUILTS ON ALL WORK WITHIN 5 BUSINESS DAYS OF COMPLETION

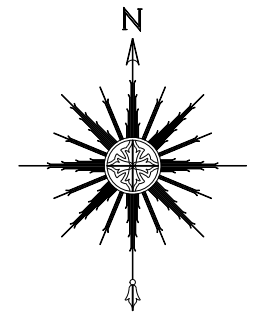

517-999-9999  
1800 Grand River Ave  
Lansing MI 48906

**PROPRIETARY  
INFORMATION NOT FOR  
DISCLOSURE**

This Set of Plans contains confidential or proprietary information, and the recipient must not disclose, copy, re-create, or distribute the plans or the information contained therein, either directly or indirectly, to other entities or individuals without written or express permission from ACD.NET

**DRAWING DISCLAIMER**

Facility Locations are general in nature, ACD.NET will not be held accountable for the accuracy of the information provided on these drawings. Contact the Local ONE CALL AGENCY 72 HOURS PRIOR TO CONSTRUCTION FOR EXACT UTILITY LOCATIONS AT:

|  |  |  |
|--|--|--|
| <small>MISS DIG<br/>1-800-482-7171</small> | <small>O.U.P.S.<br/>1-800-362-2764</small> | <small>INDIANA811<br/>1-800-382-5544</small> |
|--|--|--|

CAD Standard Ver. 72919

**Project Manager**

P. Gray

**Permitting**

P. Gray

**Transport Manager**

G. Gould

|                 |             |
|-----------------|-------------|
| <b>Drawn By</b> | <b>Date</b> |
| K. Ngo          | 2/14/22     |

|                 |             |
|-----------------|-------------|
| <b>As Built</b> | <b>Date</b> |
|                 |             |

**Revisions**

| REV # | DESCRIPTION  | BY  | DATE    |
|-------|--|-----|---------|
| 1     | Added Handholes  | KN  | 3/14/22 |
| 2     | Fixed Dim. changed main run to (2) conduit and drop to bldg to (1) conduit | DTW | 4-26-22 |
|       |  |     |         |
|       |  |     |         |
|       |  |     |         |
|       |  |     |         |
|       |  |     |         |
|       |  |     |         |

**Exhibit:** N/A

|                 |           |                |                              |                        |
|-----------------|-----------|----------------|------------------------------|------------------------|
| Remarks:        |           |                | PEACHTREE ID:                |                        |
| SCALE: 1" = NTS | TRS:      |                |                              |                        |
| COUNTY: Wexford | TOWNSHIP: | CITY: Cadillac | PROJECT ID: LC017297FO035823 | CUSTOMER NUMBER: 17297 |

**NOTES**

|  |                  |   |                            |   |
|--|------------------|---|----------------------------|---|
| Proposed Anchor Distance and Direction                           | Reg Sidewalk<br> | Fiber Count W/ Segment Number<br>       | Man Hole<br>               | <b>Typical Line Types</b><br><br><br><br><br><br><br><br><br><br><br><br><br><br><br><br><br><br><br><br><br><br> |
| Proposed ACD Communications Poles                                |                  | Fiber Termination Point<br>             | Storm Drain<br>            |   |
| Proposed ACD NON Communications Pole                             |                  | ACD Splice Case Six Way<br>             | ACD Regen Cabinet<br>      |   |
| Colocation Poles (ACD Communication Equipment on Existing Poles) |                  | ACD Splice Case Four Way<br>            | TRS Section Corner<br>     |   |
| Joint Use Pole NON Transformer                                   |                  | ACD Splice Case Three Way<br>           | Fire Hydrant<br>           |   |
| Joint Use Pole Transformer                                       |                  | ACD Splice Case Two Way<br>             | Location Address<br>       |   |
| Foreign Pole Indicator   |                  | ACD Fiber Tap Capsule<br>               | Foliage<br>                |   |
| Joint Use Pole NON Transformer- UNUSED                           |                  | ACD RE-Box<br>                          | Centerline Marker<br>      |   |
| Joint Use Pole Transformer- UNUSED                               |                  | Foreign Splice Case<br>                 | Station Marker<br>         |   |
| Street Light   |                  | Storage Loop w/ Footage and Segment<br> | Use of Double Dead End<br> |   |
| Existing Traffic Signal Pole                                     |                  | ACD Buried Cable Marker<br>             |                            |   |
| Pole Number Marker   |                  | ACD Hand Hole 17" x 12"<br>             |                            |   |
| Proposed Riser   |                  | ACD Hand Hole 24" x 13"<br>             |                            |   |
| Make Ready Symbol w/ Attachment and Sag Heights                  |                  | ACD Hand Hole 24" x 36"<br>             |                            |   |
| Down Ground  |                  | ACD Hand Hole 30" x 48"<br>             |                            |   |
| Bonding Clamp  |                  | Foreign Hand Hole<br>                   |                            |   |
| Fiber Overlash   |                  | Proposed Bore Pit Location<br>          | Bore Pit (size)<br>        |   |
| Overhead Guy Marker  |                  | Communications Tower<br>                |                            |   |
| Span Length and Segment ID                                       |                  |   |                            |   |

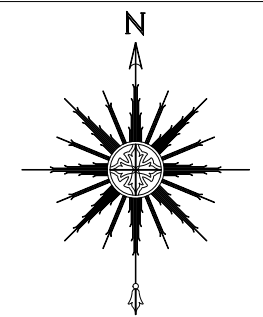

**ACD.NET**  
Advanced Communications & Data  
517-999-9999  
1800 Grand River Ave  
Lansing MI 48906

**PROPRIETARY INFORMATION NOT FOR DISCLOSURE**  
This Set of Plans contains confidential or proprietary information, and the recipient must not disclose, copy, re-create, or distribute the plans or the information contained therein, either directly or indirectly, to other entities or individuals without written or express permission from ACD.NET

**DRAWING DISCLAIMER**  
Facility Locations are general in nature, ACD.NET will not be held accountable for the accuracy of the information provided on these drawings. Contact the Local ONE CALL AGENCY 72 HOURS PRIOR TO CONSTRUCTION FOR EXACT UTILITY LOCATIONS AT:  
M.I.S.S. DIG 1-800-482-7171 O.U.P.S. 1-800-362-2764 INDIANA811 1-800-382-5544  
CAD Standard Ver. 72919

|                          |             |
|--------------------------|-------------|
| <b>Project Manager</b>   |             |
| P. Gray                  |             |
| <b>Permitting</b>        |             |
| P. Gray                  |             |
| <b>Transport Manager</b> |             |
| G. Gould                 |             |
| <b>Drawn By</b>          | <b>Date</b> |
| K. Ngo                   | 2/14/22     |
| <b>As Built</b>          | <b>Date</b> |
|                          |             |

|                  |  |           |             |
|------------------|--|-----------|-------------|
| <b>Revisions</b> |  |           |             |
| <b>REV #</b>     | <b>DESCRIPTION</b>   | <b>BY</b> | <b>DATE</b> |
| 1                | Added Handholes  | KN        | 3/14/22     |
| 2                | Fixed Dim. changed main run to (2) conduit and drop to bldg to (1) conduit | DTW       | 4-26-22     |

Our Match Lines can be found in the lower right hand corner and represents the neighboring page numbers.

|           |            |           |
|-----------|------------|-----------|
| WEST PAGE | NORTH PAGE | EAST PAGE |
|           | PAGE       |           |
|           | SOUTH PAGE |           |

|                 |           |                |                              |                        |  |
|-----------------|-----------|----------------|------------------------------|------------------------|--|
| Remarks:        |           |                | PEACHTREE ID:                |                        |  |
| SCALE: 1" = NTS | TRIS:     |                |                              |                        |  |
| COUNTY: Wexford | TOWNSHIP: | CITY: Cadillac | PROJECT ID: LC017297FO035823 | CUSTOMER NUMBER: 17297 |  |

|                     |
|---------------------|
| <b>Exhibit:</b> N/A |
| SYMBOLS             |
| LEGEND              |





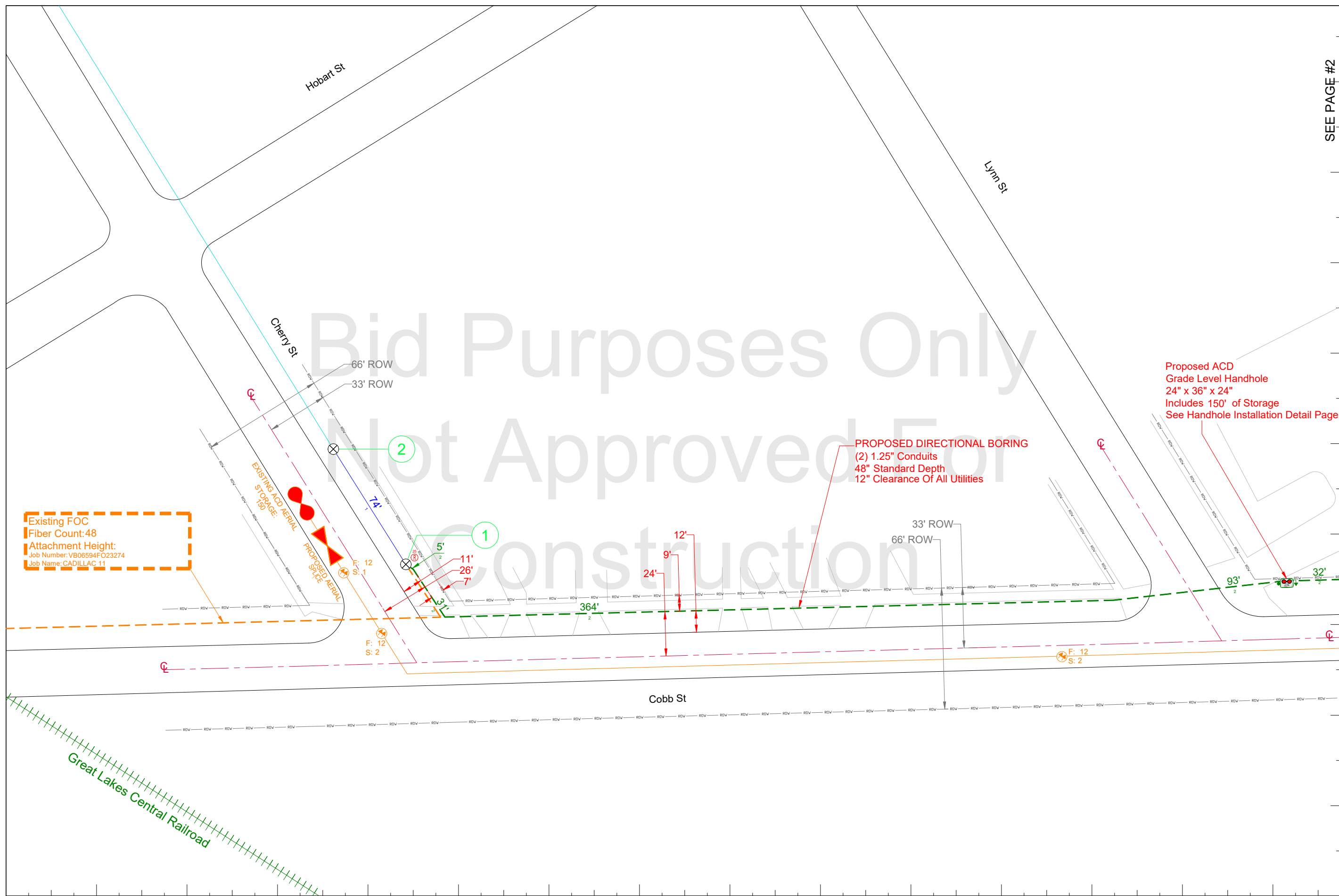

SEE PAGE #2

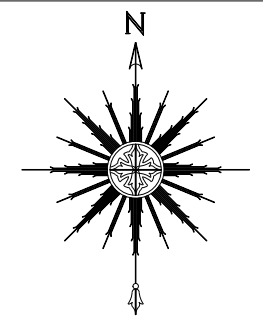

517-999-9999  
 1800 Grand River Ave  
 Lansing MI 48906

**PROPRIETARY INFORMATION NOT FOR DISCLOSURE**

This Set of Plans contains confidential or proprietary information, and the recipient must not disclose, copy, re-create, or distribute the plans or the information contained therein, either directly or indirectly, to other entities or individuals without written or express permission from ACD.NET

**DRAWING DISCLAIMER**

Facility Locations are general in nature, ACD.NET will not be held accountable for the accuracy of the information provided on these drawings. Contact the Local ONE CALL AGENCY 72 HOURS PRIOR TO CONSTRUCTION FOR EXACT UTILITY LOCATIONS AT:

|                |                |                |
|----------------|----------------|----------------|
| MISS DIG       | O.U.P.S.       | INDIANA811     |
| 1-800-482-7171 | 1-800-362-2764 | 1-800-382-5544 |

CAD Standard Ver. 72919

**Project Manager**

P. Gray

**Permitting**

P. Gray

**Transport Manager**

G. Gould

**Drawn By Date**

K. Ngo 2/14/22

**As Built Date**

**Revisions**

| REV # | DESCRIPTION  | BY  | DATE    |
|-------|--|-----|---------|
| 1     | Added Handholes  | KN  | 3/14/22 |
| 2     | Fixed Dim. changed main run to (2) conduit and drop to bldg to (1) conduit | DTW | 4-26-22 |
|       |  |     |         |
|       |  |     |         |
|       |  |     |         |
|       |  |     |         |
|       |  |     |         |
|       |  |     |         |

**Exhibit:** N/A

|                 |                  |                     |                              |
|-----------------|------------------|---------------------|------------------------------|
| Remarks:        |                  | PEACHTREE ID: 35823 |                              |
| SCALE: 1" = 50' | TRS: T21N R9W S3 |                     |                              |
| COUNTY: Wexford | TOWNSHIP:        | CITY: Cadillac      | PROJECT ID: LC017297FO035823 |
|                 |                  |                     | CUSTOMER NUMBER: 17297       |

SEE PAGE #1

SEE PAGE #3

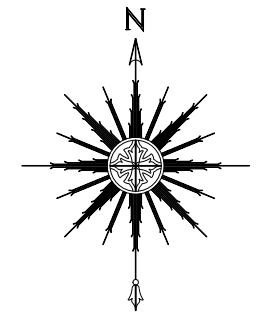

517-999-9999  
1800 Grand River Ave  
Lansing MI 48906

**PROPRIETARY**  
**INFORMATION NOT FOR DISCLOSURE**  
This Set of Plans contains confidential or proprietary information, and the recipient must not disclose, copy, re-create, or distribute the plans or the information contained therein, either directly or indirectly, to other entities or individuals without written or express permission from ACD.NET

**DRAWING DISCLAIMER**  
Facility Locations are general in nature, ACD.NET will not be held accountable for the accuracy of the information provided on these drawings. Contact the Local ONE CALL AGENCY 72 HOURS PRIOR TO CONSTRUCTION FOR EXACT UTILITY LOCATIONS AT:  
MISS DIG 1-800-482-7171 O.U.P.S. 1-800-362-2764 INDIANA811 1-800-382-5544  
CAD Standard Ver. 72919

**Project Manager**

P. Gray

**Permitting**

P. Gray

**Transport Manager**

G. Gould

**Drawn By** K. Ngo **Date** 2/14/22

**As Built** **Date**

**Revisions**

| REV # | DESCRIPTION  | BY  | DATE    |
|-------|--|-----|---------|
| 1     | Added Handholes  | KN  | 3/14/22 |
| 2     | Fixed Dim. changed main run to (2) conduit and drop to bldg to (1) conduit | DTW | 4-26-22 |
|       |  |     |         |
|       |  |     |         |
|       |  |     |         |
|       |  |     |         |
|       |  |     |         |
|       |  |     |         |

**Exhibit:** N/A

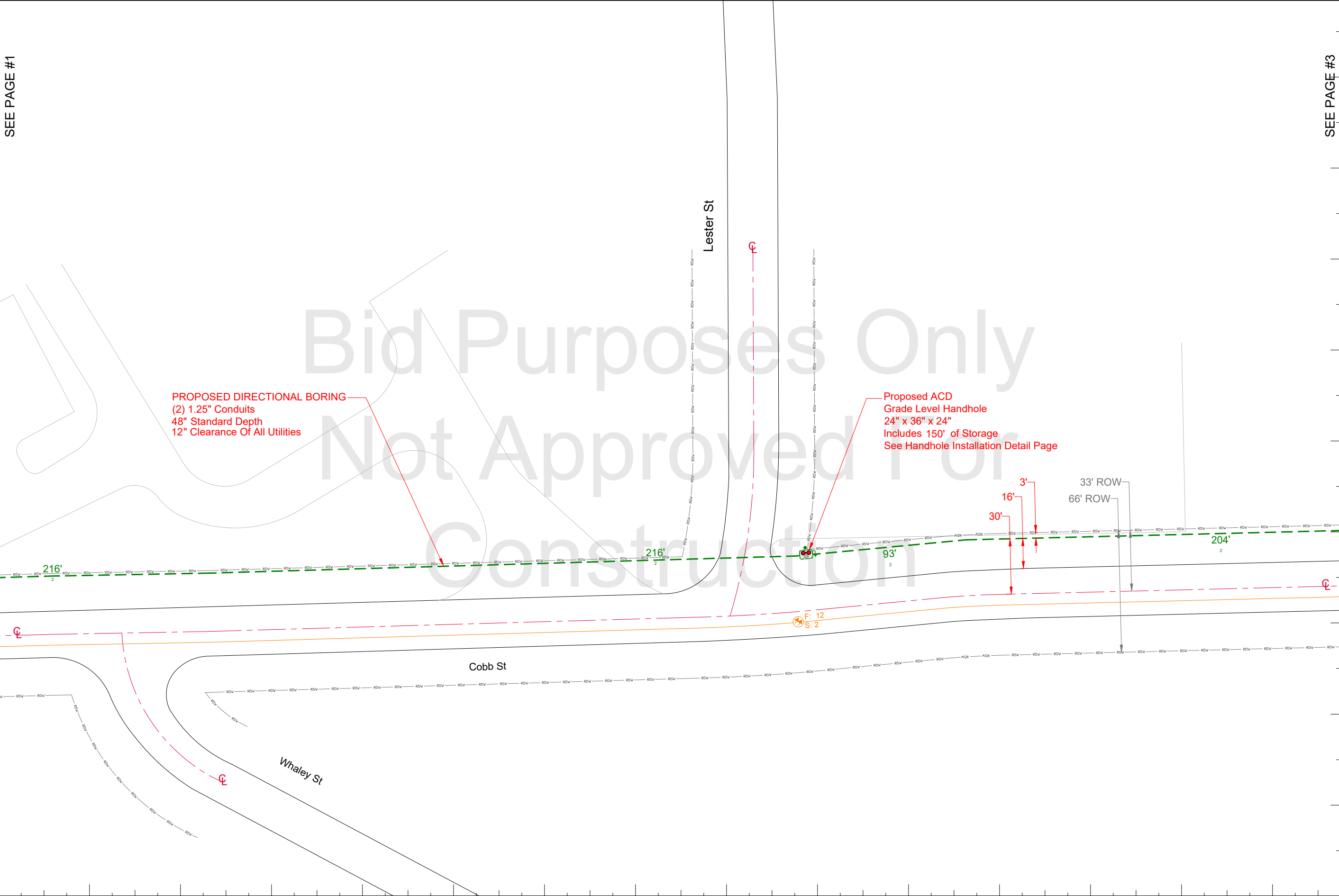

**PROPOSED DIRECTIONAL BORING**  
(2) 1.25" Conduits  
48" Standard Depth  
12" Clearance Of All Utilities

**Proposed ACD**  
**Grade Level Handhole**  
24" x 36" x 24"  
Includes 150' of Storage  
See Handhole Installation Detail Page

Remarks: PEACHTREE ID: 35823

SCALE: 1" = 50' TRS: T21N R9W S3

COUNTY: Wexford TOWNSHIP: CITY: Cadillac PROJECT ID: LC017297FO035823 CUSTOMER NUMBER: 17297

SEE PAGE #2

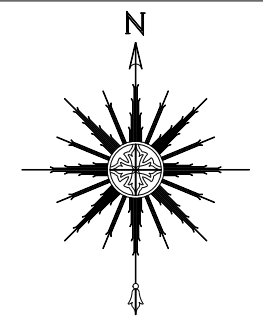
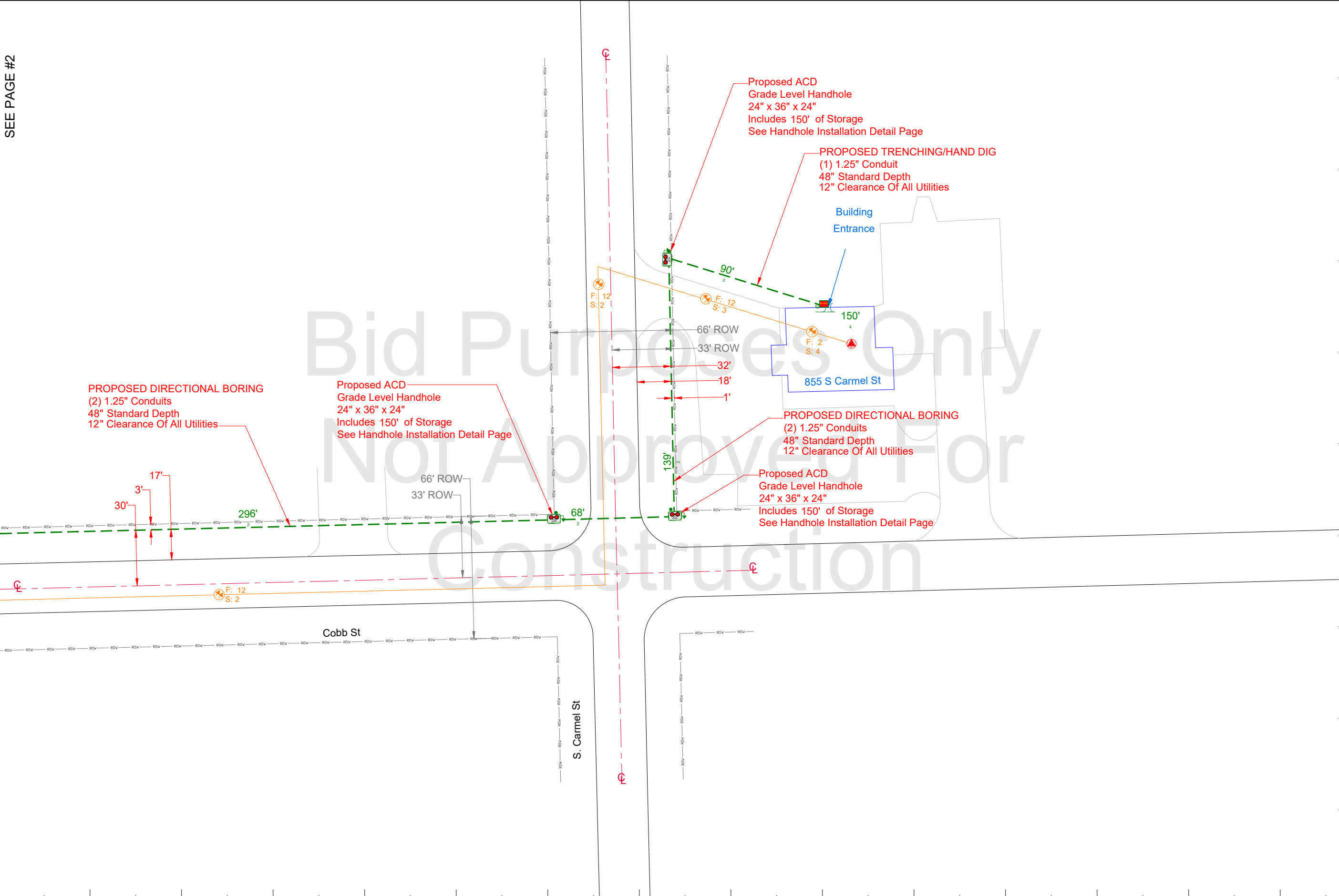

517-999-9999  
1800 Grand River Ave  
Lansing MI 48906

**PROPRIETARY**  
**INFORMATION NOT FOR DISCLOSURE**  
This Set of Plans contains confidential or proprietary information, and the recipient must not disclose, copy, re-create, or distribute the plans or the information contained therein, either directly or indirectly, to other entities or individuals without written or express permission from ACD.NET

**DRAWING DISCLAIMER**  
Facility Locations are general in nature, ACD.NET will not be held accountable for the accuracy of the information provided on these drawings. Contact the Local ONE CALL AGENCY 72 HOURS PRIOR TO CONSTRUCTION FOR EXACT UTILITY LOCATIONS AT:  
MISS DIG 1-800-482-7171 O.U.P.S. 1-800-362-2764 INDIANA811 1-800-382-5544  
CAD Standard Ver. 72919

**Project Manager**

P. Gray

**Permitting**

P. Gray

**Transport Manager**

G. Gould

**Drawn By Date**

K. Ngo 2/14/22

**As Built Date**

**Revisions**

| REV # | DESCRIPTION  | BY  | DATE    |
|-------|--|-----|---------|
| 1     | Added Handholes  | KN  | 3/14/22 |
| 2     | Fixed Dim. changed main run to (2) conduit and drop to bldg to (1) conduit | DTW | 4-26-22 |
|       |  |     |         |
|       |  |     |         |
|       |  |     |         |
|       |  |     |         |
|       |  |     |         |
|       |  |     |         |
|       |  |     |         |

**Exhibit:** N/A

|                 |                  |                        |                              |
|-----------------|------------------|------------------------|------------------------------|
| Remarks:        |                  | PEACHTREE ID: 35823    |                              |
| SCALE: 1" = 50' | TRS: T21N R9W S3 |                        |                              |
| COUNTY: Wexford | TOWNSHIP:        | CITY: Cadillac         | PROJECT ID: LC017297FO035823 |
|                 |                  | CUSTOMER NUMBER: 17297 |                              |