



Advanced Communications & Data

KEPS Technologies, Inc. d/b/a ACD.net
FIBER OPTIC CABLE ROUTE

Project Number
LC081506FO33066

[517-999-9999](tel:517-999-9999)

1800 Grand River Ave
Lansing MI 48906

CONSTRUCTION NOTES

1. CONTRACTOR SHALL EMAIL SUNDEN.COLIN@ACD.NET WITH DAILY STATUS UPDATES AND ONCE WORK IS COMPLETE
2. MUNICIPALITY MUST BE NOTIFIED AT LEAST 48 HOURS BEFORE ANY WORK COMMENCES
3. ALL APPROPRIATE PERMITS AND ASSOCIATED DRAWINGS SHALL BE ON-SITE AT ALL TIMES DURING CONSTRUCTION
4. NOTIFY THE APPROPRIATE UTILITY NOTIFICATION SERVICE 72 HOURS PRIOR TO CONSTRUCTION.
MICHIGAN- MISS DIG (1-800-482-1711), OHIO- O.U.P.S. (1-800-362-2764) OR INDIANA- INDIANA811 (1-800-382-5544)
5. ALL UTILITIES MUST BE FIELD VERIFIED
6. ALL HANDHOLES ARE TO INCLUDE 150' OF COILED FIBER FOR STORAGE
7. NEW INSTALLATION SHALL MAINTAIN 18" CLEARANCE FROM ALL EXISTING UTILITIES UNLESS NOTED OTHERWISE
8. ALL ROAD AND DRIVEWAY CROSSINGS WILL BE DIRECTIONAL BORED
9. CONSTRUCTION SHALL NOT DEVIATE FROM APPROVED PLANS WITHOUT WRITTEN CONSENT FROM BOTH THE MUNICIPALITY AND AN AUTHORIZED ACD.NET REPRESENTATIVE
10. PROPER SIGNAGE AND TRAFFIC CONTROL IS REQUIRED BEFORE STARTING ANY WORK WITHIN THE PUBLIC RIGHT OF WAY
11. ALL BACKFILL MATERIAL WITHIN THE ROAD RIGHT OF WAY OR NEAR SIDEWALKS AND PATHWAYS SHALL MEET THE REQUIREMENTS OF MDOT CLASS II MATERIAL, COMPACTED TO 95% OF ITS MAXIMUM DENSITY IN SUCCESSIVE LAYERS THAT ARE NO MORE THAN 12" THICK, UNLESS OTHERWISE AUTHORIZED
12. ALL SODDED AREAS THAT MAY DISTURBED DURING CONSTRUCTION ARE TO BE RESTORED WITH 3" QUALITY TOP SOIL, SEED AND MULCH
13. CONTRACTOR SHALL PROVIDE AS-BUILTS ON ALL WORK WITHIN 5 BUSINESS DAYS OF COMPLETION

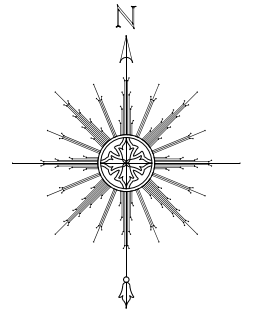

517-999-9999
1800 Grand River Ave
Lansing MI 48906

PROPRIETARY INFORMATION NOT FOR DISCLOSURE

This Set of Plans contains confidential or proprietary information, and the recipient must not disclose, copy, re-create, or distribute the plans or the information contained therein, either directly or indirectly, to other entities or individuals without written or express permission from ACD.NET

DRAWING DISCLAIMER

Facility Locations are general in nature. ACD.NET will not be held accountable for the accuracy of the information provided on these drawings. Contact the Local ONE CALL AGENCY 72 HOURS PRIOR TO CONSTRUCTION FOR EXACT UTILITY LOCATIONS AT:

MISS DIG 1-800-482-7171	O.U.P.S 1-800-362-2764	INDIANA811 1-800-382-5544
----------------------------	---------------------------	------------------------------

CAD Standard Ver. 72919

Project Manager

C. SUNDEN

Permitting

C. SUNDEN

Transport Manager

G. GOULD

Drawn By Date

DTW 3-26-21

As Built Date

Revisions

REV #	DESCRIPTION	BY	DATE
1	CHANGED NOTES-MICRO TRENCHING	JA	01/07/22

Exhibit: N/A

Remarks:			PEACHTREE ID: 33066	
SCALE: 1" = NTS	TRS:			
COUNTY: HILLSDALE	TOWNSHIP:	CITY: HILLSDALE	PROJECT ID: LC081506FO33066	CUSTOMER NUMBER: 81506

NOTES

Proposed Anchor Distance and Direction		Fiber Count W/ Segment Number		Man Hole		Typical Line Types Rail Road Tracks Proposed Underground Fiber Existing Underground Fiber Right Of Way Boundary Side Walk and Driveway Fiber Design Line Aerial Fiber Center Line Water Main Forced Water Main Storm Sewer Sanitary Sewer Gas Main Foreign UG Fiber AT&T UG Fiber UG Electric Oil Line Fence TRS Boundary Civil Boundary Property Boundary Water Boundary
Proposed ACD Communications Poles		Fiber Termination Point		Storm Drain		
Proposed ACD NON Communications Pole		ACD Splice Case Six Way		ACD Regen Cabinet		
Colocation Poles (ACD Communication Equipment on Existing Poles)		ACD Splice Case Four Way		TRS Section Corner		
Joint Use Pole NON Transformer		ACD Splice Case Three Way		Fire Hydrant		
Joint Use Pole Transformer		ACD Splice Case Two Way		Location Address		
Foreign Pole Indicator		ACD Fiber Tap Capsule		Foliage		
Joint Use Pole NON Transformer- UNUSED		ACD RE-Box		Centerline Marker		
Joint Use Pole Transformer- UNUSED		Foreign Splice Case		Station Marker		
Street Light		Storage Loop w/ Footage and Segment		Use of Double Dead End		
Existing Traffic Signal Pole		ACD Buried Cable Marker				
Pole Number Marker		ACD Hand Hole 17" x 12"				
Proposed Riser		ACD Hand Hole 24" x 13"				
Make Ready Symbol w/ Attachment and Sag Heights		ACD Hand Hole 24" x 36"				
Down Ground		ACD Hand Hole 30" x 48"				
Bonding Clamp		Foreign Hand Hole				
Fiber Overlash		Proposed Bore Pit Location				
Overhead Guy Marker		Communications Tower				
Span Length and Segment ID						

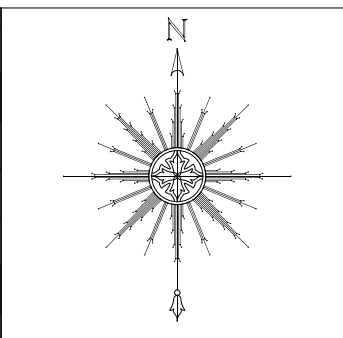

ACD.NET
 Advanced Communications & Data
 517-999-9999
 1800 Grand River Ave
 Lansing MI 48906

PROPRIETARY INFORMATION NOT FOR DISCLOSURE
 This Set of Plans contains confidential or proprietary information, and the recipient must not disclose, copy, re-create, or distribute the plans or the information contained therein, either directly or indirectly, to other entities or individuals without written or express permission from ACD.NET

DRAWING DISCLAIMER
 Facility Locations are general in nature. ACD.NET will not be held accountable for the accuracy of the information provided on these drawings. Contact the Local ONE CALL AGENCY 72 HOURS PRIOR TO CONSTRUCTION FOR EXACT UTILITY LOCATIONS AT:
 MISS DIG 1-800-482-7171 | O.U.P.S 1-800-362-2764 | INDIANA811 1-800-382-5544
 CAD Standard Ver. 72919

Project Manager

C. SUNDEN

Permitting

C. SUNDEN

Transport Manager

G. GOULD

Drawn By DTW **Date** 3-26-21

As Built **Date**

Revisions

REV #	DESCRIPTION	BY	DATE
1	CHANGED NOTES-MICRO TRENCHING	JA	01/07/22

Our Match Lines can be found in the lower right hand corner and represents the neighboring page numbers.

WEST PAGE	NORTH PAGE	EAST PAGE
	PAGE	
	SOUTH PAGE	

Exhibit: N/A

Remarks:				PEACHTREE ID: 33066	
SCALE: 1" = NTS	TRIS:				
COUNTY: HILLSDALE	TOWNSHIP:	CITY: HILLSDALE	PROJECT ID: LC081506FO33066	CUSTOMER NUMBER: 81506	
					SYMBOLS
					LEGEND

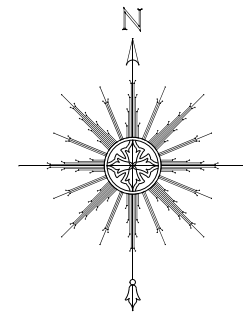

Advanced Communications & Data
 517-999-9999
 1800 Grand River Ave
 Lansing MI 48906

**PROPRIETARY
 INFORMATION NOT FOR
 DISCLOSURE**

This Set of Plans contains confidential or proprietary information, and the recipient must not disclose, copy, re-create, or distribute the plans or the information contained therein, either directly or indirectly, to other entities or individuals without written or express permission from ACD.NET

DRAWING DISCLAIMER

Facility Locations are general in nature, ACD.NET will not be held accountable for the accuracy of the information provided on these drawings. Contact the Local ONE CALL AGENCY 72 HOURS PRIOR TO CONSTRUCTION FOR EXACT UTILITY LOCATIONS AT:

MISS DIG 1-800-482-7171	O.U.P.S. 1-800-362-2764	INDIANA811 1-800-382-5544
----------------------------	----------------------------	------------------------------

CAD Standard Ver. 72919

Project Manager

C. SUNDEN

Permitting

C. SUNDEN

Transport Manager

G. GOULD

Drawn By Date

DTW 3-26-21

As Built Date

Revisions

REV #	DESCRIPTION	BY	DATE
1	CHANGED NOTES-MICRO TRENCHING	JA	01/07/22

Exhibit: N/A

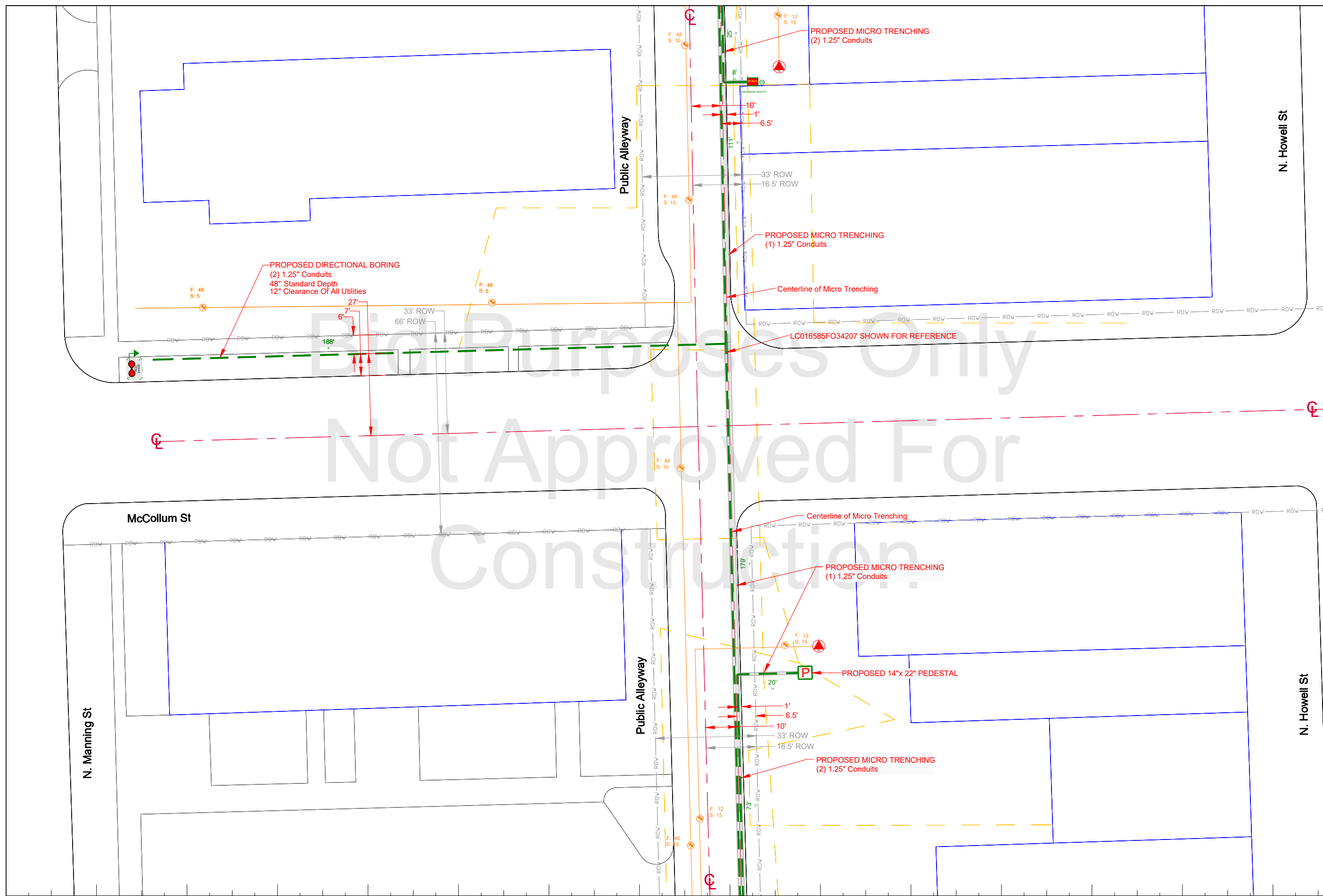

Remarks: PEACHTREE ID: 33066

SCALE: 1" = 30' TRS: S27 T6S R3W

COUNTY: HILLSDALE TOWNSHIP: CITY: HILLSDALE PROJECT ID: LC081506FO33066 CUSTOMER NUMBER: 81506

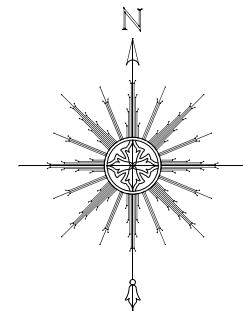

517-999-9999
1800 Grand River Ave
Lansing MI 48906

PROPRIETARY
INFORMATION NOT FOR
DISCLOSURE

This Set of Plans contains confidential or proprietary information, and the recipient must not disclose, copy, re-create, or distribute the plans or the information contained therein, either directly or indirectly, to other entities or individuals without written or express permission from ACD.NET

DRAWING DISCLAIMER

Facility Locations are general in nature, ACD.NET will not be held accountable for the accuracy of the information provided on these drawings. Contact the Local ONE CALL AGENCY 72 HOURS PRIOR TO CONSTRUCTION FOR EXACT UTILITY LOCATIONS AT:

MISS DIG	O.U.P.S.	INDIANA811
1-800-482-7171	1-800-362-2764	1-800-382-5544

CAD Standard Ver. 72919

Project Manager

C. SUNDEN

Permitting

C. SUNDEN

Transport Manager

G. GOULD

Drawn By **Date**

DTW 3-26-21

As Built **Date**

Revisions

REV #	DESCRIPTION	BY	DATE
1	CHANGED NOTES-MICRO TRENCHING	JA	01/07/22

Exhibit: N/A

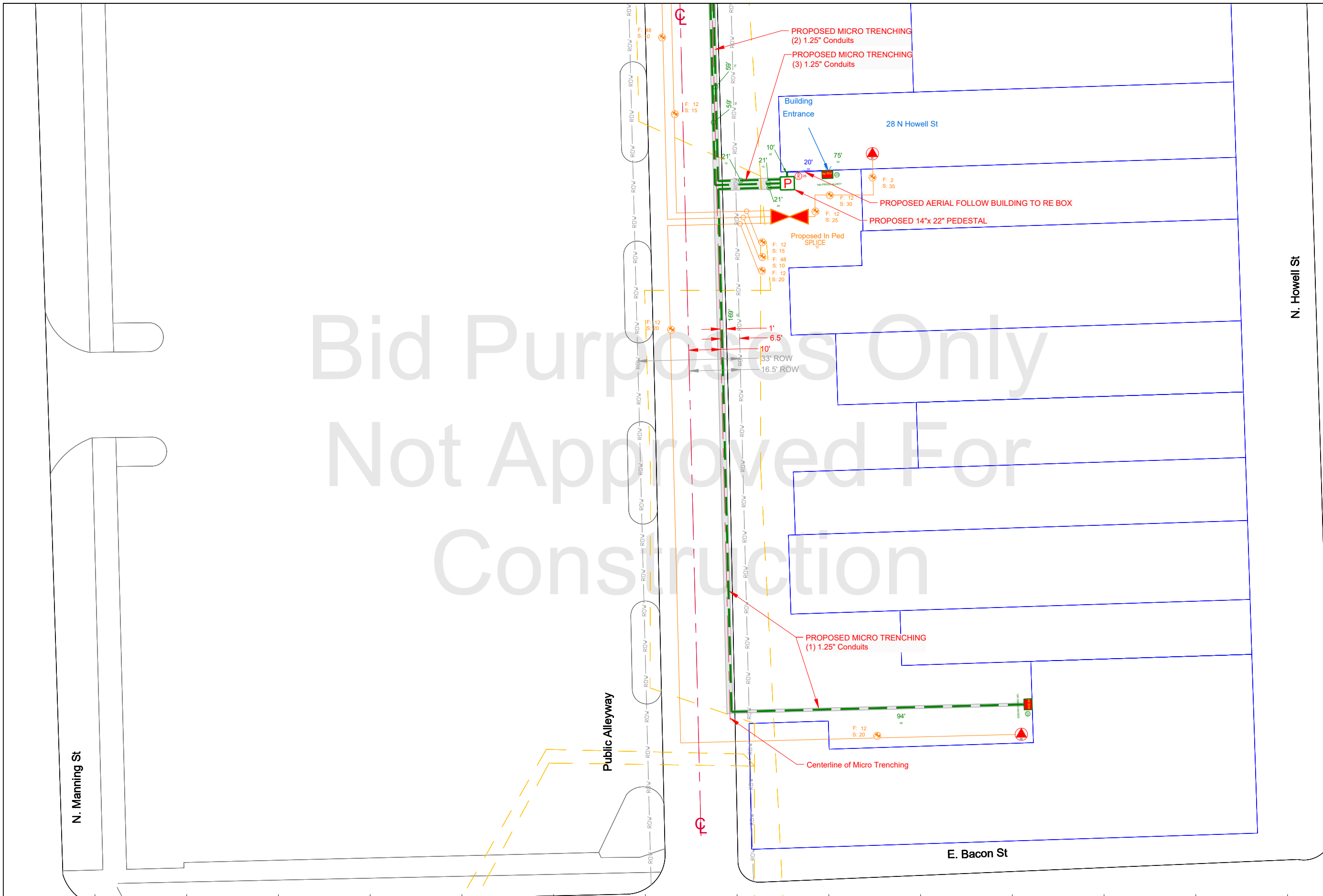

Bid Purposes Only
Not Approved For
Construction

Remarks:		PEACHTREE ID: 33066	
SCALE: 1" = 30'	TRS: S27 T6S R3W		
COUNTY: HILLSDALE	TOWNSHIP:	CITY: HILLSDALE	PROJECT ID: LC081506FO33066
			CUSTOMER NUMBER: 81506